

**BAV56W**

Parameter	Symbol	Rating	Unit
Repetitive Reverse Voltage	$V_{RRM}$	85	V
Continuous reverse voltage	$V_R$	75	V
Continuous forward current	$I_{F(1)}$	215	mA
	$I_{F(2)}$	125	mA
Repetitive peak forward current	$I_{FRM}$	450	mA
Non-repetitive Peak Forward Current	$I_{FSM(1)(t=1\text{ S})}$	0.5	A
	$I_{FSM(2)(t=1\text{ mS})}$	1.0	A
	$I_{FSM(3)(t=1\mu\text{S})}$	4.0	A
Total power dissipation	$P_{tot}$	200	mW
Junction Temperature	$T_j$	150	
Storage Temperature Range	$T_{stg}$	-55 150	

Parameter	Symbol	Test Conditions	Min	Typ	Max	Unit
Forward Voltage	$V_F$	$I_F=1\text{mA}$			715	mV
		$I_F=10\text{mA}$			855	mV
		$I_F=50\text{mA}$			1.0	V
		$I_F=150\text{mA}$			1.25	V

Instantaneous Revers Tc0.0033 TD0269.7803 Tm-0.00070I50269.7803 Tm-0.R Tm-0nt225.7062 41403 Tm(t)8.69I

**/ Electrical Characteristic Curve**

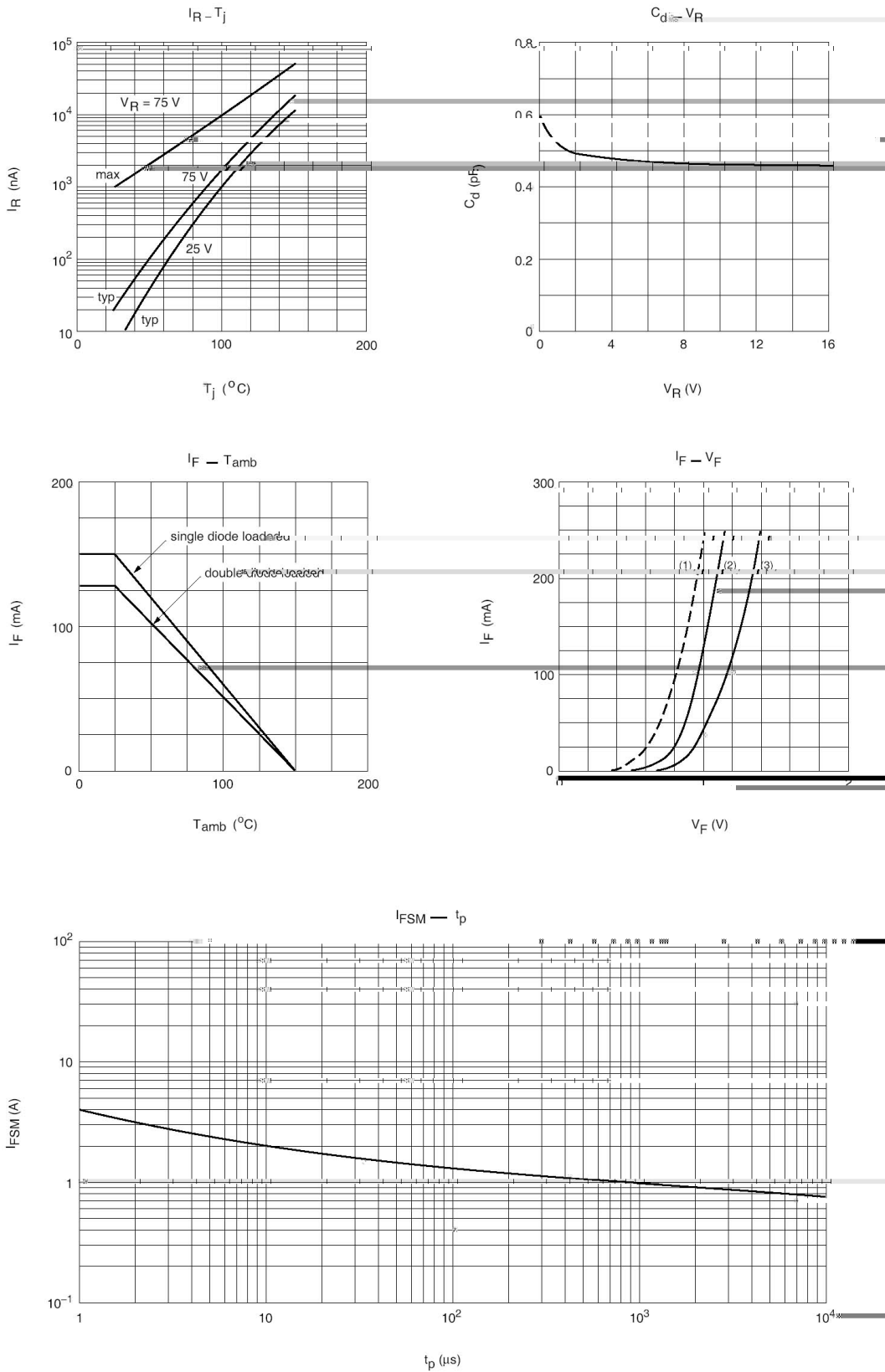

**/ Package Dimensions**

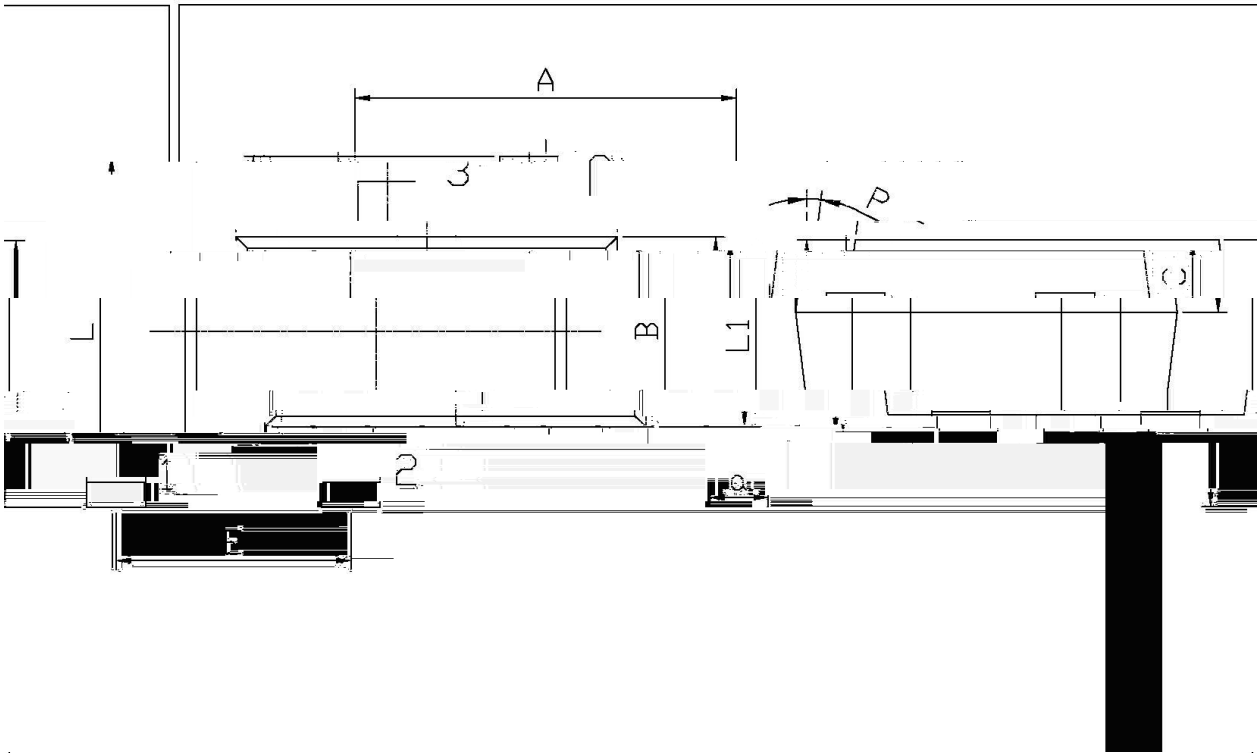
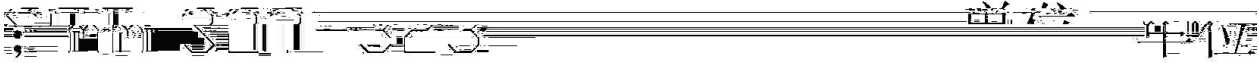

Dimensions in Millimeters		Symbol	
Max	Min	MIN	Max
2.35	C	0.30	0.50
1.15			
0.43		1.20	2.00
0.43		1.40	2.2
0.20		0.20	0.40
0.35	7° P		
		B	1.5
		L1	0.85
		A	1.95

/ **Marking Instructions**

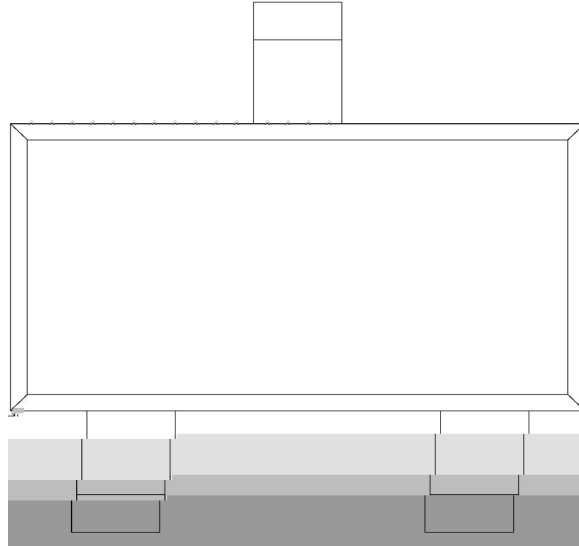

7. 在器件表面烙丝印字

8. 烙丝印字内容如下

Note:

**BAV56W**  
Rev.A May.-2016