

KF (\$) - = GE G Silicon PNP transistor in a TO-126F Plastic Package.

9; (*.
Complement to BD137.

Medium power linear and switching applications.

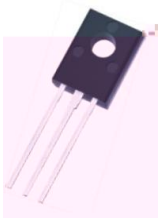
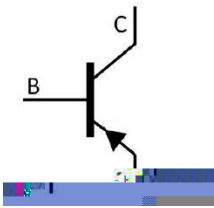

PIN1 Emitter PIN 2 Collector PIN 3 Base

| Parameter | Symbol | Rating | Unit |
|---------------------------|-----------|--------|------|
| Collector to Base Voltage | V_{CBO} | -60 | V |

/ Electrical Characteristic Curve

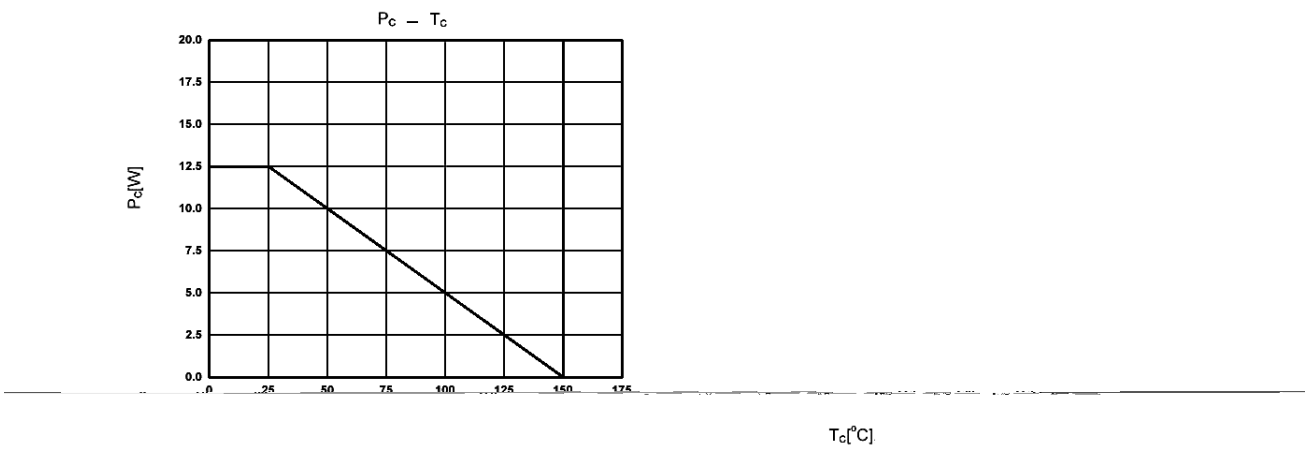
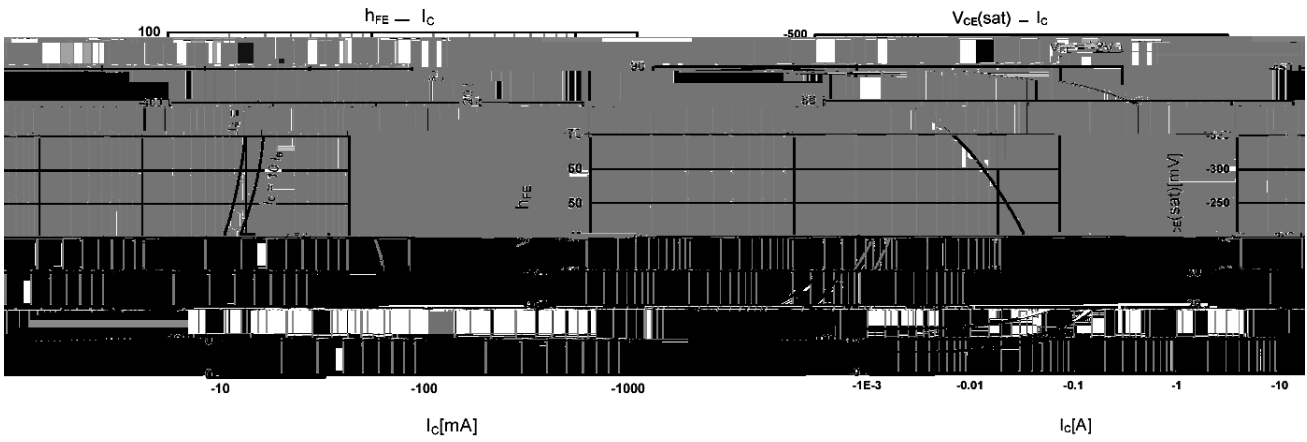

/ Package Dimensions

TU-126F

单位: mm

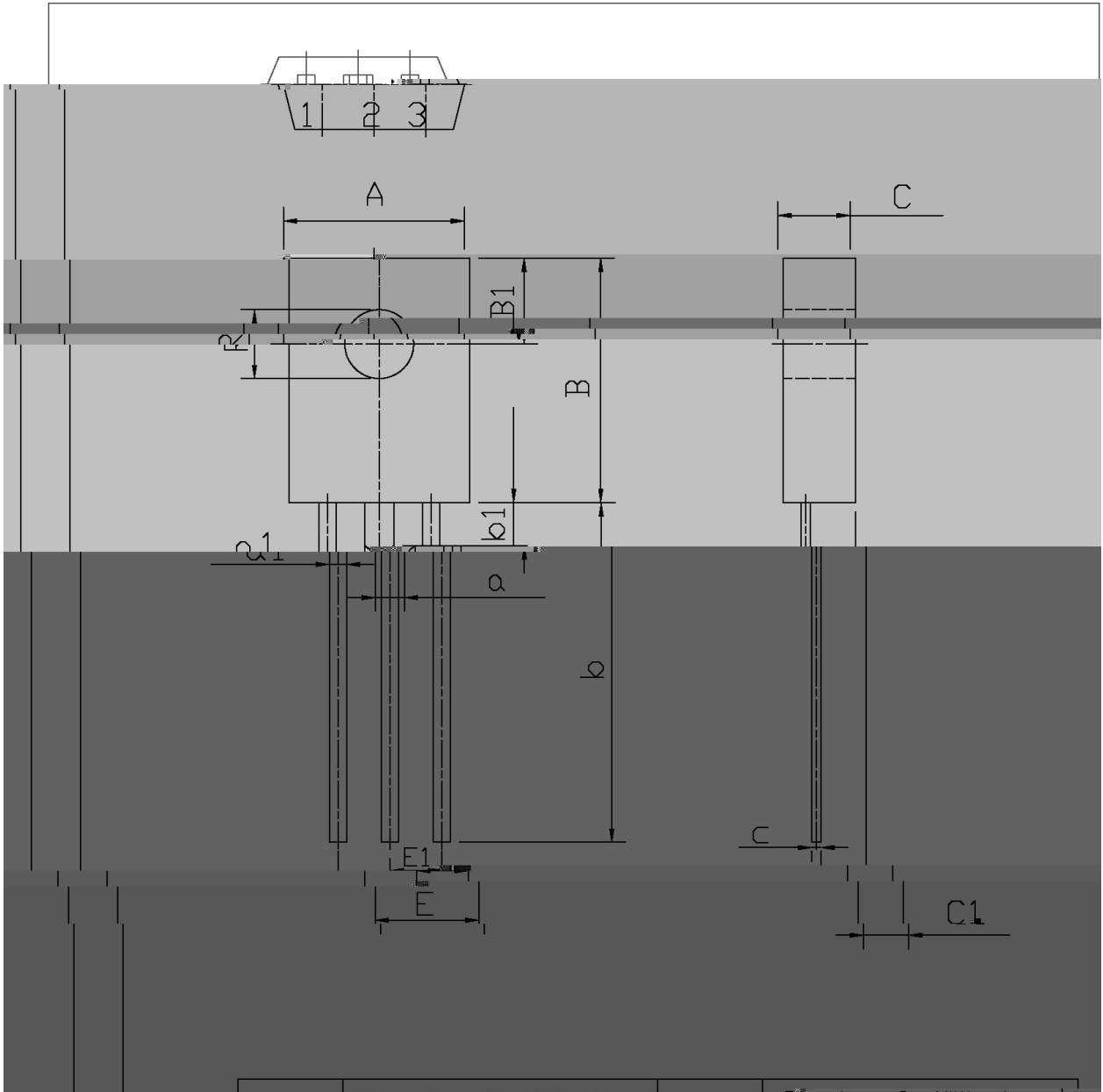

| Symbol | Min | Max | Symbol | Min | Max |
|--------|------|------|--------|------|-----|
| A | 7.8 | 8.2 | a1 | 0.65 | 0.7 |
| B | 10.9 | 11.3 | b1 | 0.65 | 0.7 |
| C | 1.2 | 1.5 | C1 | 0.65 | 0.7 |
| E | 1.2 | 1.5 | E1 | 0.65 | 0.7 |

/ Marking Instructions

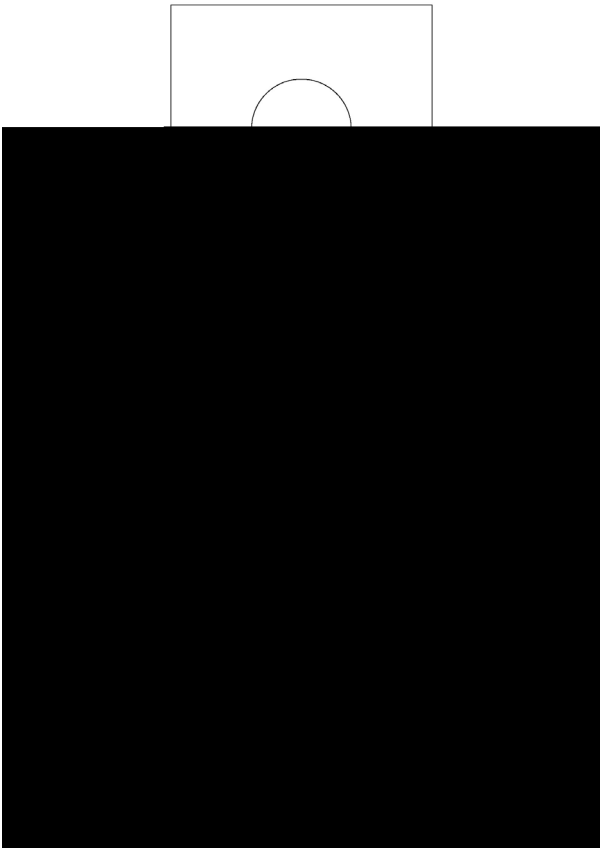

- 9|
- 9; (*/
- (- 1
- !!!!
- Note:
- BR: Company Code
- BD138: Product Type.
- 16: h_{FE} Classifications Symbol
- ****: Lot No. Code, code change with Lot No.

() / Temperature Profile for Dip Soldering(Pb-Free)



Note:

- | | | | | | |
|---|--------|-----|------------|--------|---|
| 1 | 25 | 150 | 60 | 90sec; | 1.Preheating:25~150 , Time:60~90sec. |
| 2 | 255..5 | | 5..0.5sec; | | 2.Peak Temp.:255..5 , Duration:5..0.5sec. |
| 3 | | 2 | 10 /sec. | | 3. Cooling Speed: 2~10 /sec. |

/ Resistance to Soldering Heat Test Conditions

270..5 10..1 sec. Temp.:270±5 Time:10±1 sec

/ Packaging SPEC.

/ BULK

| Package Type | Units | | | Dimension (unit mm ³) |
|--------------|------------|-----------------|-----------------|-----------------------------------|
| | Units/Tube | Tubes/Inner Box | Units/Inner Box | |
| U00 | 1000 | 20 | 20000 | 1000 |
| U01 | 1000 | 20 | 20000 | 1000 |
| U02 | 1000 | 20 | 20000 | 1000 |
| U03 | 1000 | 20 | 20000 | 1000 |
| U04 | 1000 | 20 | 20000 | 1000 |
| U05 | 1000 | 20 | 20000 | 1000 |
| U06 | 1000 | 20 | 20000 | 1000 |
| U07 | 1000 | 20 | 20000 | 1000 |
| U08 | 1000 | 20 | 20000 | 1000 |
| U09 | 1000 | 20 | 20000 | 1000 |
| U10 | 1000 | 20 | 20000 | 1000 |
| U11 | 1000 | 20 | 20000 | 1000 |
| U12 | 1000 | 20 | 20000 | 1000 |
| U13 | 1000 | 20 | 20000 | 1000 |
| U14 | 1000 | 20 | 20000 | 1000 |
| U15 | 1000 | 20 | 20000 | 1000 |
| U16 | 1000 | 20 | 20000 | 1000 |
| U17 | 1000 | 20 | 20000 | 1000 |
| U18 | 1000 | 20 | 20000 | 1000 |
| U19 | 1000 | 20 | 20000 | 1000 |
| U20 | 1000 | 20 | 20000 | 1000 |