

/ Descriptions

KF \$) - * E GE

/ Features

+, \$, ' N 9I) J9- //9

/ Applications

/ Equivalent Circuit

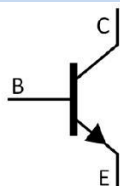

/ Pinning

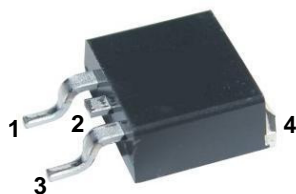

/ h_{FE} Classifications & Marking

BR2SD718B

/ Electrical Characteristic Curve

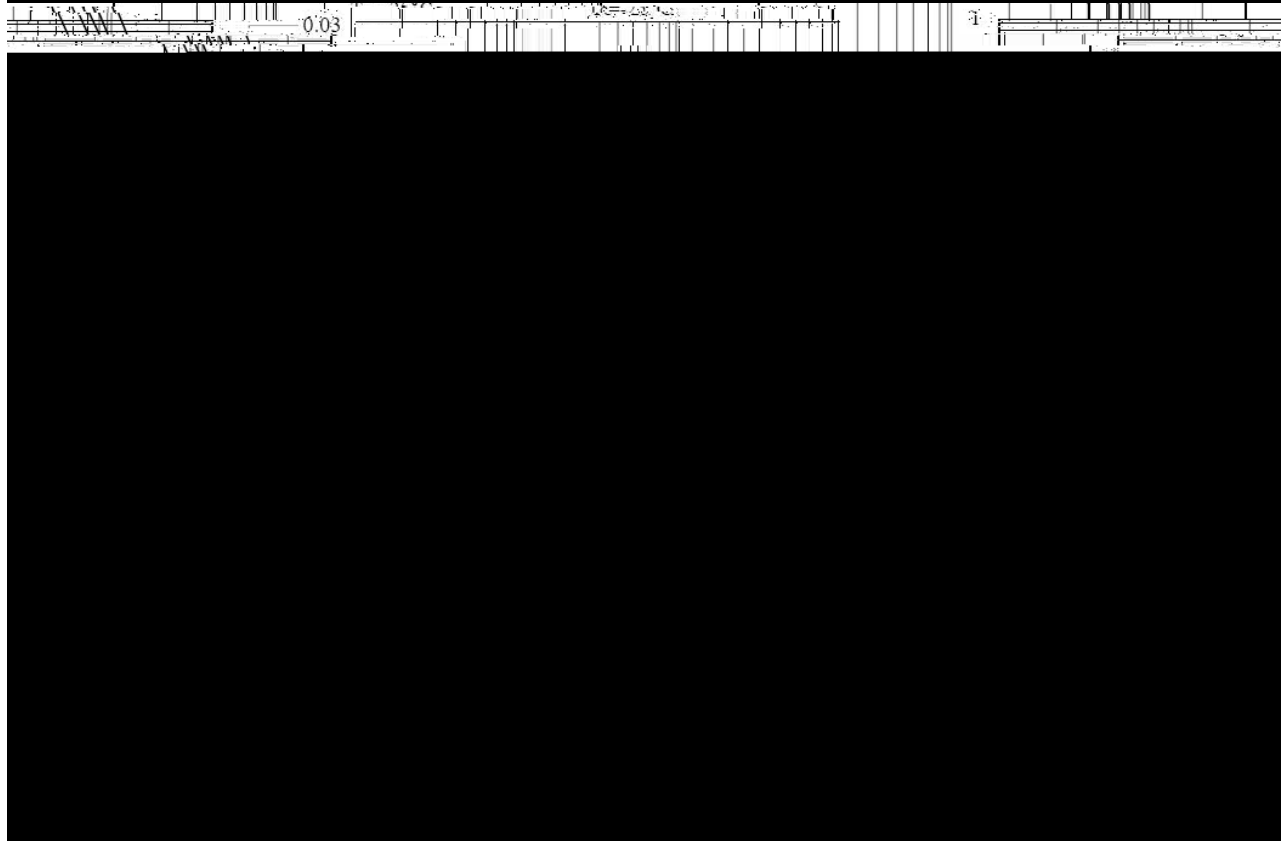
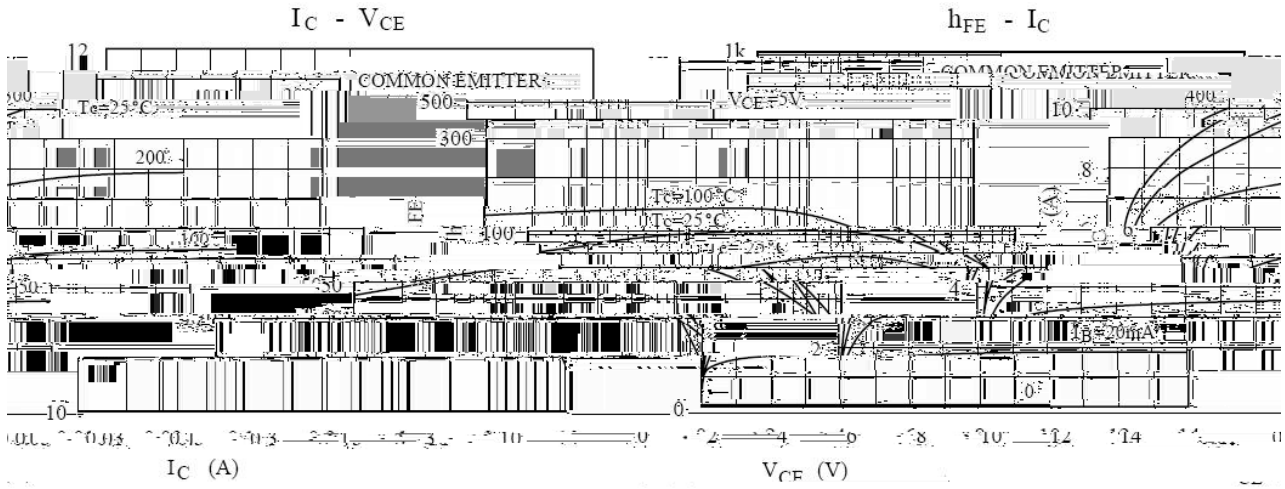

/ Package Dimensions

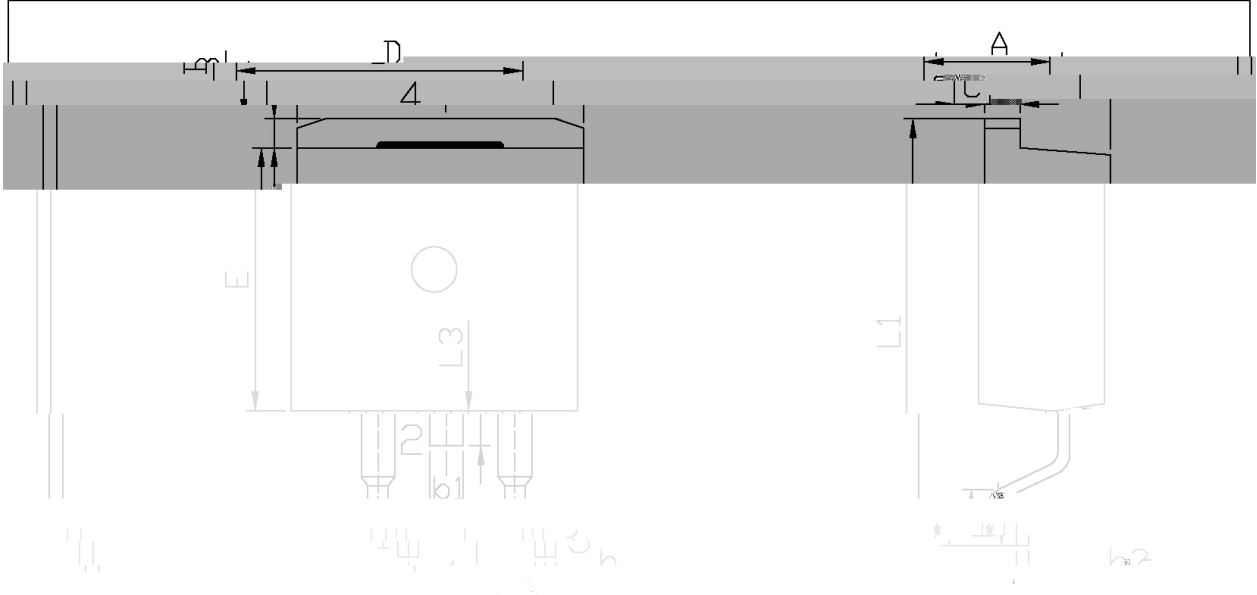

Max	Min	Max	Min
9.40	4.30	4.70	9.00
2.74	1.00	1.40	2.24
15.00	b1	1.15	L1
16.00		1.35	

/ Marking Instructions

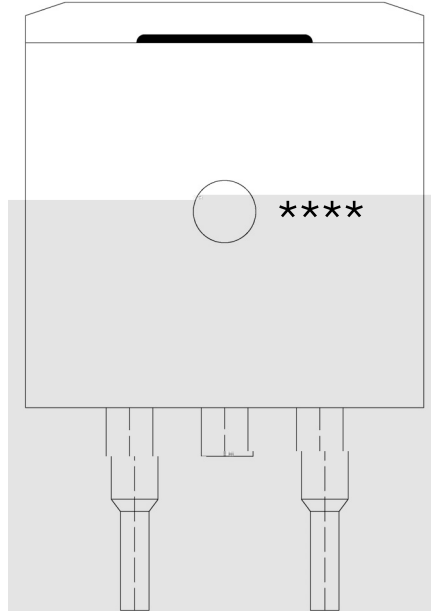

9|

; . (/

F 1

—=<

!!!!

() / Temperature Profile for IR Reflow Soldering(Pb-Free)

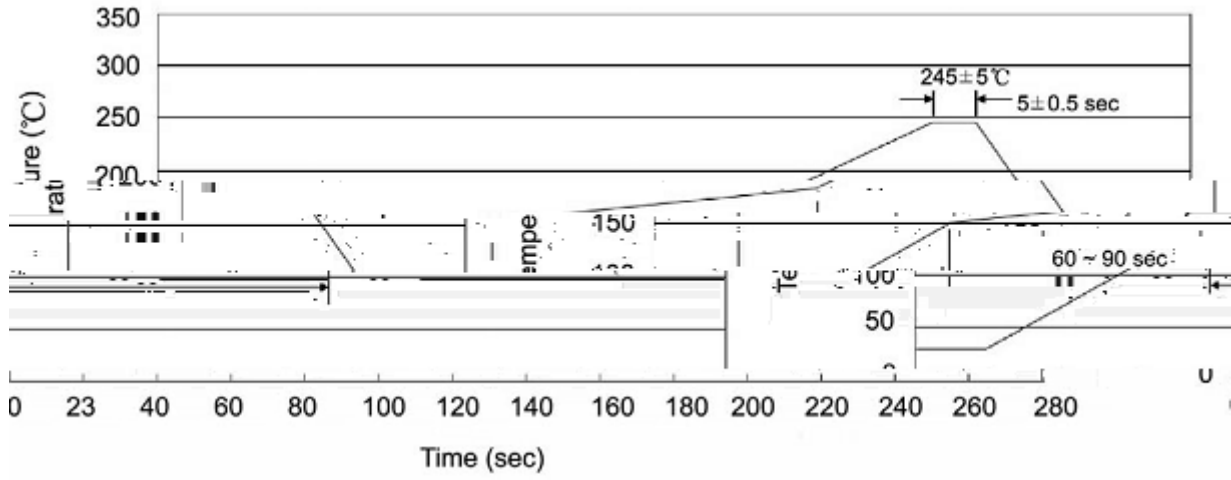

/ Resistance to Soldering Heat Test Conditions

... ..