

BR3CG5350TA

Rev.A Sep.-2022

/ Descriptions

> JKL 8M NN. < O < P Q R S T U V

Silicon PNP transistor in a SOT-89 Plastic Package.

/ Features

WXYZ [\] 0 \$ %) * V

Low $V_{CE(sat)}$, high current, HF product.

/ Applications

^ ; _ ` a b c d e f g h i j k l m n o c d \ p V

General purpose switching and muting, LCD back-lighting, supply line switching circuits.

/ Equivalent Circuit

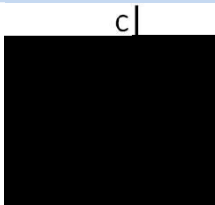

/ Pinning

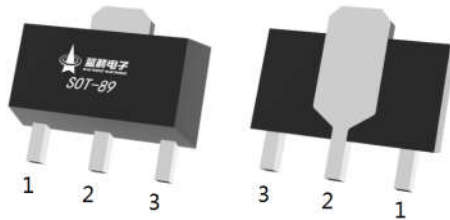

PIN1 q Base

PIN 2 q Collector

PIN 3 q Emitter

/ Marking

| | |
|---------|--------------|
| Marking | HS46 * ** |
|---------|--------------|

BR3CG5350TA

Rev.A Sep.-2022



DATA SHEET

| Parameter | Symbol | Rating | Unit |
|--|--------------|---------|------|
| Collector to Base Voltage | V_{CBO} | -50 | V |
| Collector to Emitter Voltage | V_{CEO} | -50 | V |
| Emitter to Base Voltage | V_{EBO} | -5 | V |
| Collector Current - Continuous | I_C | -3 | A |
| Peak collector current | I_{CM} | -5 | A |
| Collector Base - Continuous | I_B | -0.5 | A |
| Total power dissipation _(y) | $P_{tot(y)}$ | 550 | mW |
| Junction Temperature | T_j | 150 | |
| Storage Temperature Range | T_{stg} | -65 150 | |

yz{|}~\•€•V

| Parameter | Symbol | Test Conditions | Min | Typ | Max | Unit |
|------------------------------|-------------|---------------------------------|-----|-----|------|---------|
| Collector Cut-Off Current | I_{CBO} | $V_{CB}=-50V$ $I_E=0$ | | | -100 | nA |
| Collector Cut-Off Current | I_{CBO} | $V_{CB}=-50V$ $I_E=0$ $T_j=150$ | | | -50 | μA |
| Collector cut-off current | I_{CES} | $V_{CE}=-50V$ $V_{BE}=0$ | | | -100 | nA |
| Emitter Base Cut-Off Current | I_{EBO} | $V_{EB}=-5.0V$ $I_C=0$ | | | -100 | nA |
| | $h_{FE(1)}$ | V_D | | | | |

\$ % & " / Package Dimensions

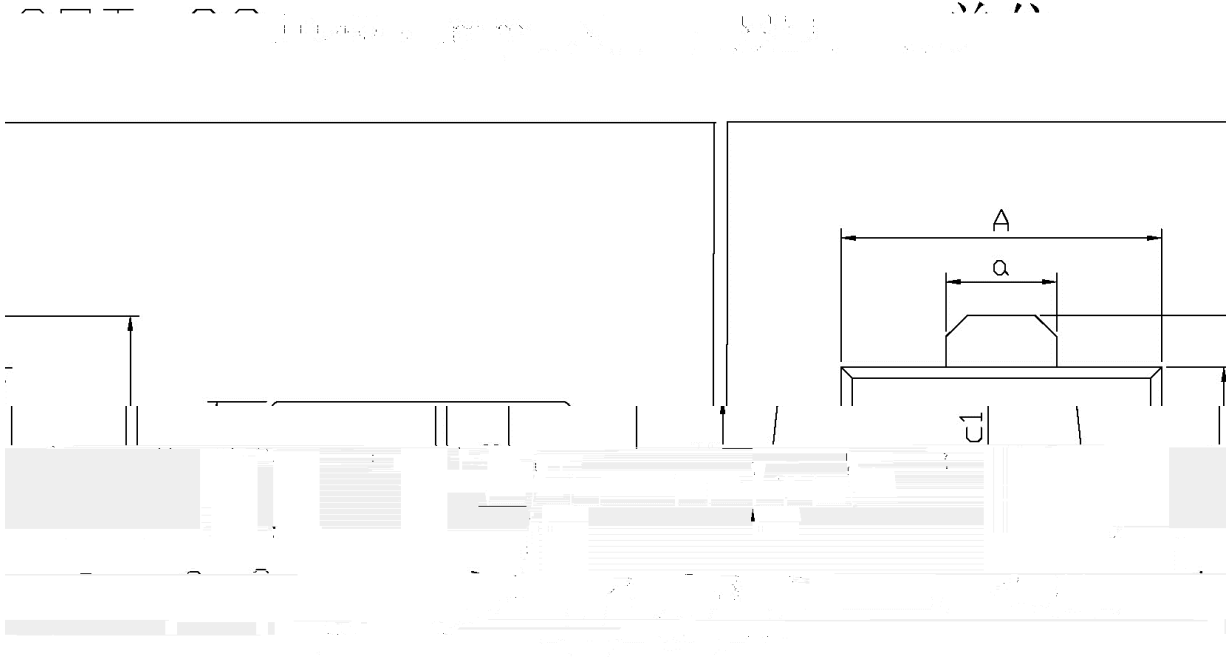

| Symbol | Dimensions In Millimeters | Symbol | Dimensions In Millimeters |
|--------|---------------------------|--------|---------------------------|
| | 1.70 | | 0.80 |
| | 0.80 | | 1.20 |

BR3CG5350TA
Rev.A Sep.-2022



DATA SHEET

BR3CG5350TA
Rev.A Sep.-2022

) * + , - ! " (. /) /