

BRCS035N03DP

Rev.A Nov-2023

DATA SHEET

BRCS035N03DP

Rev.A Nov-2023



DATA SHEET

@ f Parameter		... Z Symbol	f › Rating	% y Unit
Drain-Source Voltage		V _{DSS}	30	V
Drain Current		I _D (T _C =25)	122	A
Drain Current - Pulsed		I _{DM}	260	A
Gate-Source Voltage		V _{GSS}	±20	V
Single Pulsed Avalanche Energy		E _{AS}	281	mJ
Avalanche Current		I _{AS}	26.5	A
Power Dissipation		P _D (T _C =25)	88	W
Operating and Storage Temperature Range		T _J , T _{stg}	-55 to 150	
Junction-to-Ambient	t 0 10	R _{JA}	22	/W
Junction-to-Ambient	Steady-State		50	
Junction-to-Case	Steady-State	R _{JC}	1.42	

@ f ... Z y i Ú ^ Â 4 › Á °Đ Â 4 ›
Parameter Symbol Test Conditions Min

BRCs035N03DP

Rev.A Nov-2023



DATA SHEET

@ f Parameter	... Z Symbol	y i Ú ^ Test Conditions	Â 4 › Min	Á ° › Typ	Â Ý › Max	% y Unit
Total Gate Charge	$Q_{g(10V)}$	$V_{GS}=10V$ $V_{DS}=15V$ $I_D=20A$		32		nC
Total Gate Charge	$Q_{g(4.5V)}$			15		
Gate Source Charge	Q_{gs}			5.2		
Gate Drain Charge	Q_{gd}			6.5		

Turn-On Delay Time

$t_{d(on)}$

$V_{GS}=10V$ $V_{DS}=15V$
 $R_L=0.75 \Omega$ $R_{GEN} \Omega$

BRCS035N03DP

Electrical Characteristic Curve

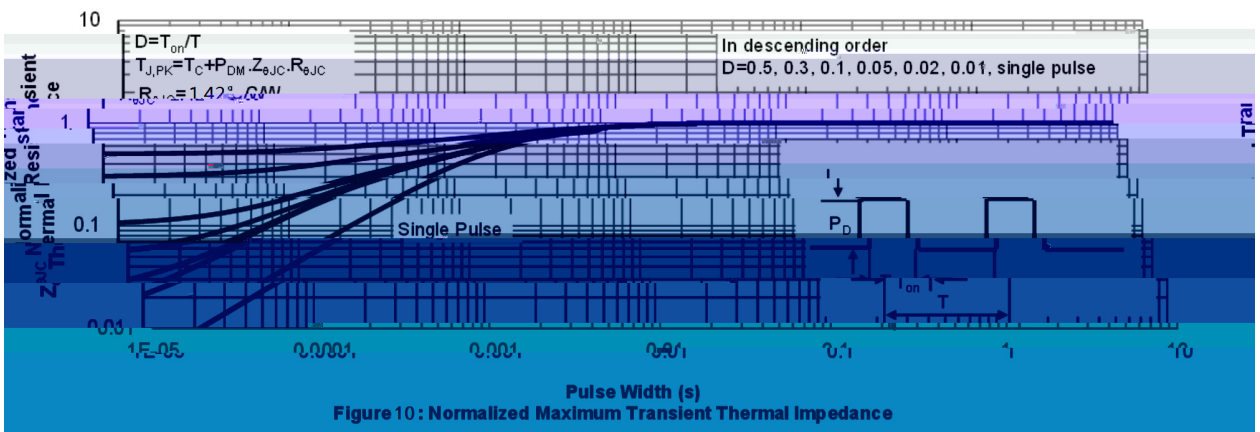
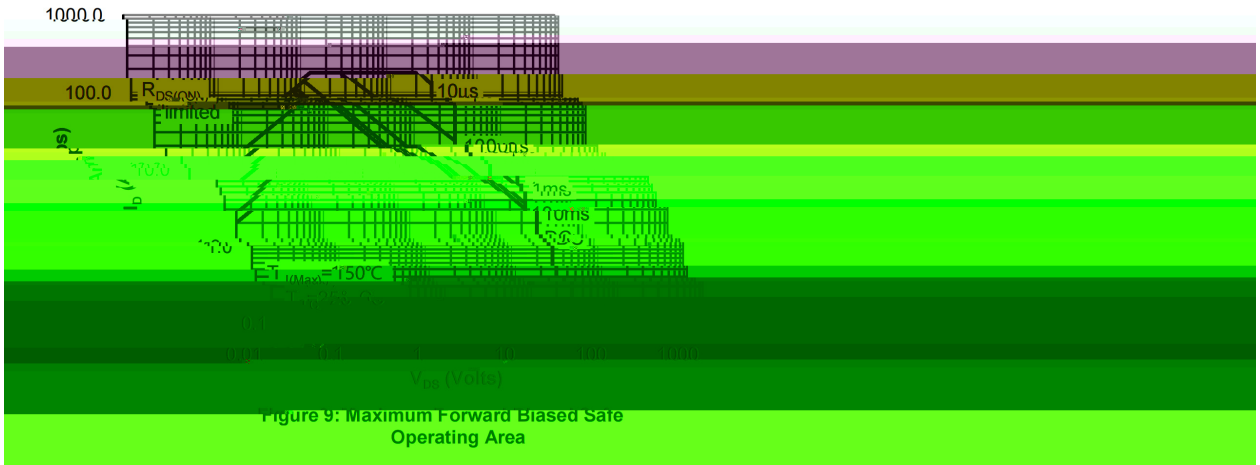
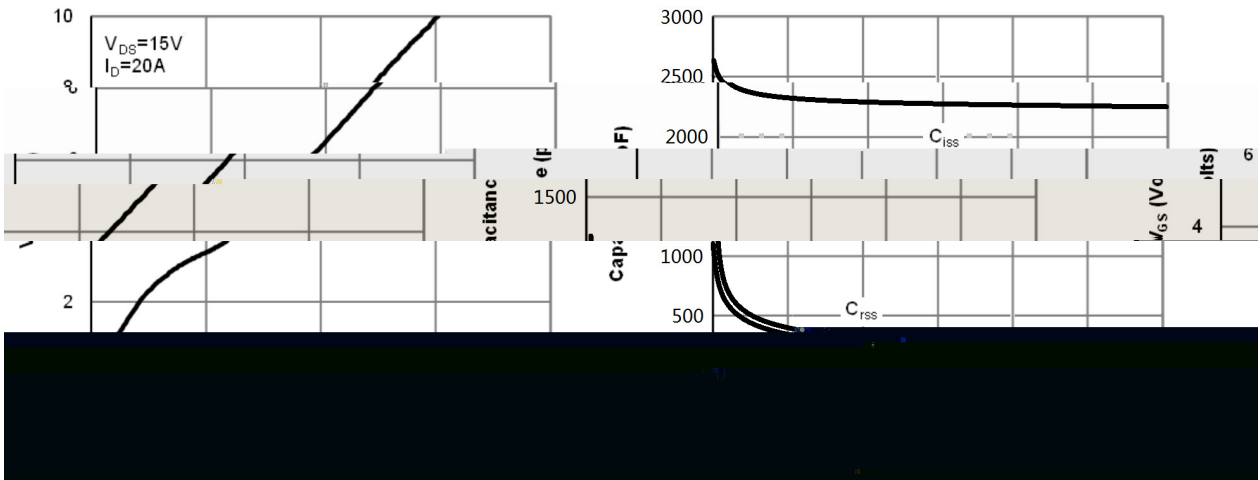

$\varnothing \square =) \phi$ / Package Dimensions

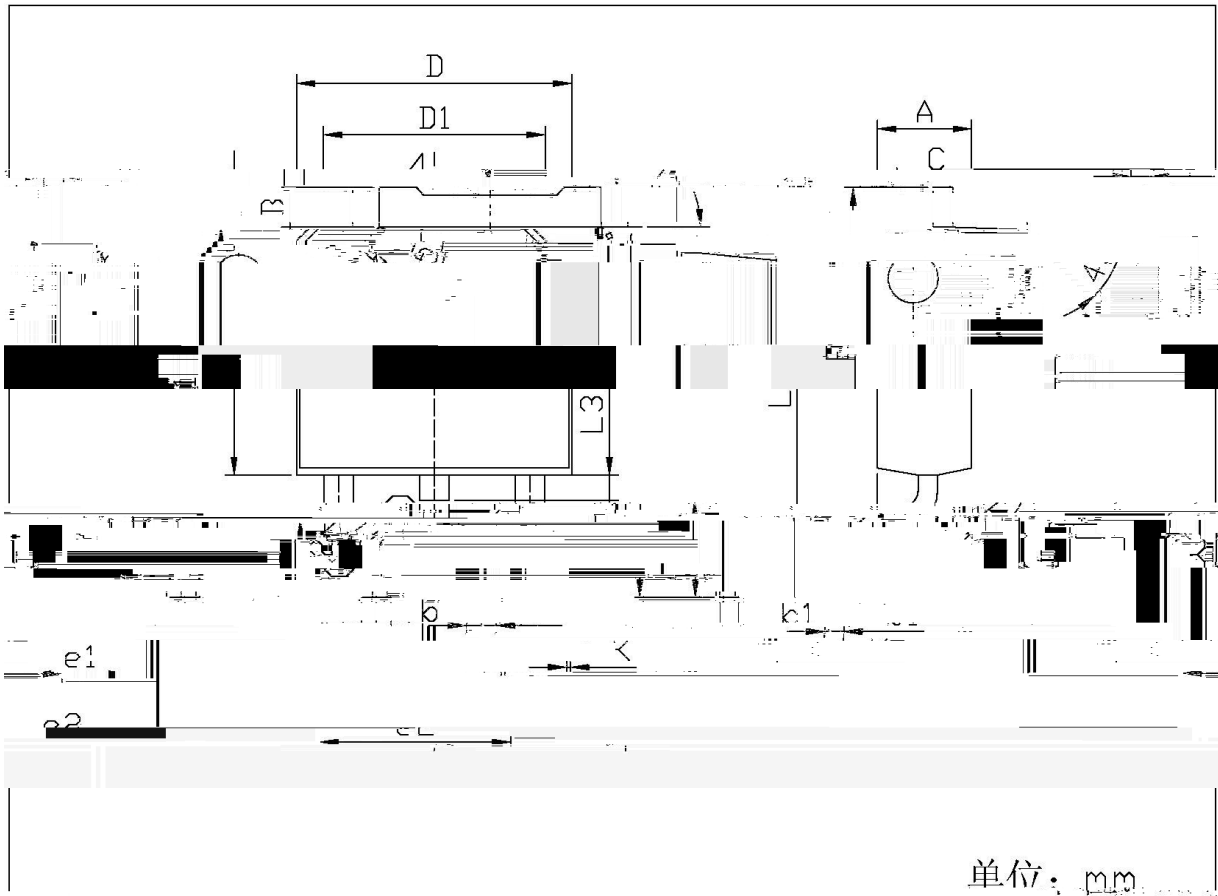

单位: mm

Dimensions		Millimeters		Dimensions		In Millimeters	
Symbol	Min	Max	Symbol	Min	Max	Symbol	Min
e1	2.24	2.34	B	0.95	1.25	A	0.70
e2	0.85	1.35	b1	0.45	0.55	L3	0.50
CL	6.65	6.75	A1	0.55	0.60	D	0.00
D1	5.10	5.50	D	0.00	0.10	D1	

T0-252

BRCS035N03DP

Rev.A Nov-2023

, M y f / Marking Instructions

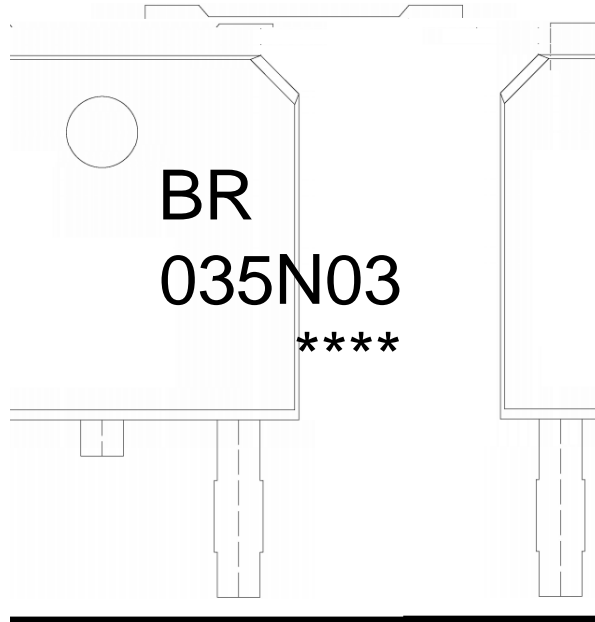

^a ç y
BR y , [W A
4 y ° Z W A
y ÿ D Z W A k š ÿ D Z J

Note:

- BR: Company Code
- 035N03: Product Type Code
- ****: Lot No. Code, code change with Lot No

BRCS035N03DP

Rev.A Nov-2023



DATA SHEET

šWD t...•Žç (x/) / :KSVKXGZ[XK 6XULORK LUX /8 8KLRU] 9URJKXOTM 6

^açy

1o•Ä½“† 150½180 - kž• 60½90sec;

2o•Q›“† 245 r5 - kž•4 Ò 5 r0.5sec;

3o•D N ò i Ò 0 , † 2½10 - /sec.

Note:

1.Preheating:150~180 - , Time:60~90sec.

2.Peak Temp.:245 r5 - , Duration:5 r0.5sec.

3. Cooling Speed: 2~10 - /sec.

ÂD /Cã p ~ »] / Resistance to Soldering Heat Test Conditions

“†y 260 r5 -

ž•y 10 r1 sec.

Temp.:260±5

Time:10±1 sec

G P á / Packaging SPEC.

2 & x / REEL

Package Type 7>û ~ E	Units ;>û !H					Dimension ;>û p . (unit /mm ³)		
	Units/Reel /--	Reels/Inner Box -- /-	Units/Inner Box /-	Inner Boxes/Outer Box - /!ç	Units/Outer Box /!ç	Reel	Inner Box	Outer Boxç