

$G_{\text{FS}} = 8 \text{ S/C}$ 'G D F J

P-Channel Enhancement Mode Field Effect Transistor in a PDFN3x 3A-8L Plastic Package.

$V_{\text{DS}} (V) = -30V$

$I_{\text{D}} = -34 \text{ A} (V_{\text{GS}} = \pm 20V)$

$R_{\text{DS(ON)}}@10V = 14\text{mR}(\text{Typ.}12.8\text{mR})$

8<: \$(' (

Qualified to AEC-Q101 Standards for High Reliability,

HF Product.

; : & :

These devices are well suited for high efficiency switching DC/DC converters and switch mode power supplies, Meet the stringent requirements of automotive applications.

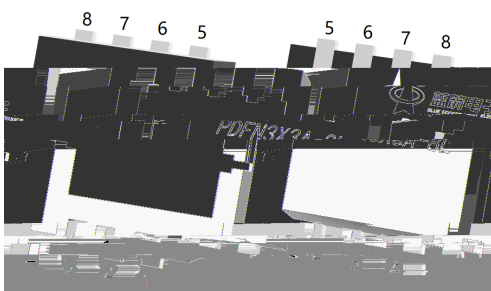
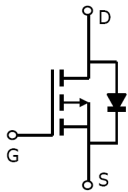

出脚	定义
Pin1	S
Pin2	C
4	S
5	C
6	S
7	C
8	S

See Marking Instructions.

Parameter		Symbol	Rating	Unit
Drain-Source Voltage		V_{DSS}	-30	V
Drain Current		$I_D(T_C=25^\circ\text{C})$	-34	A
Drain Current - Pulsed		I_{DM}	-80	A
Gate-Source Voltage		V_{GS}	± 20	V
Single Pulsed Avalanche Energy		E_{AS}	210	mJ
Avalanche Current		I_{AS}	-20	A
Power Dissipation		$P_D(T_C=25^\circ\text{C})$	29	W
Operating and Storage Temperature Range		T_J, T_{stg}	-55 to 150	
Junction-to-Ambient	$t = 10$	R_{JA}	40	/W
Junction-to-Ambient	Steady-State		75	
Junction-to-Case	Steady-State	R_{JC}	4.2	

Parameter	Symbol	Test Conditions	Min	Typ	Max	Unit
Drain-Source Breakdown Voltage	BV_{DSS}	$I_D=-250\text{ A}$ $V_{GS}=0V$	-30			V
Zero Gate Voltage Drain Current	I_{DSS}	$V_{DS}=-30V$				

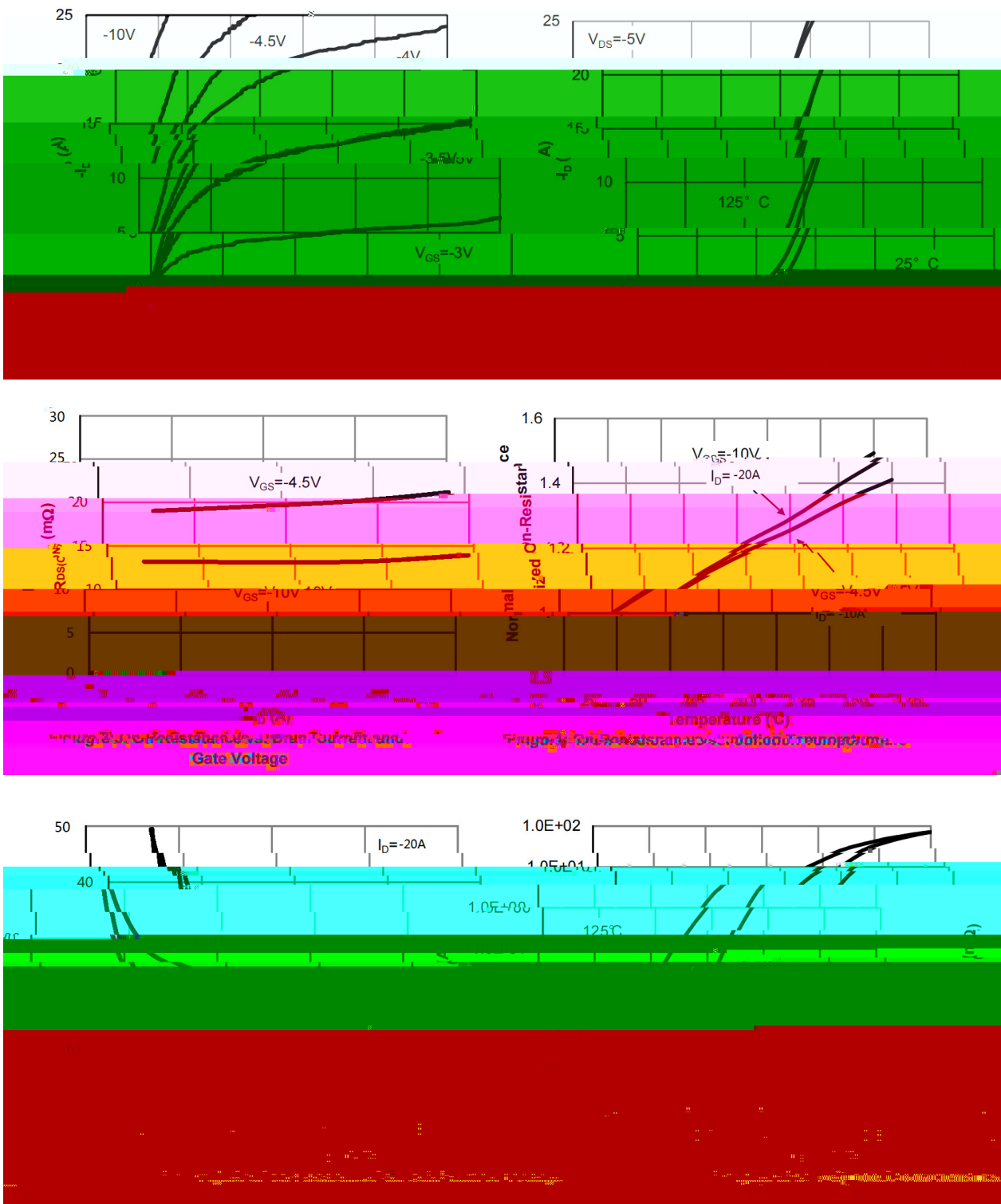

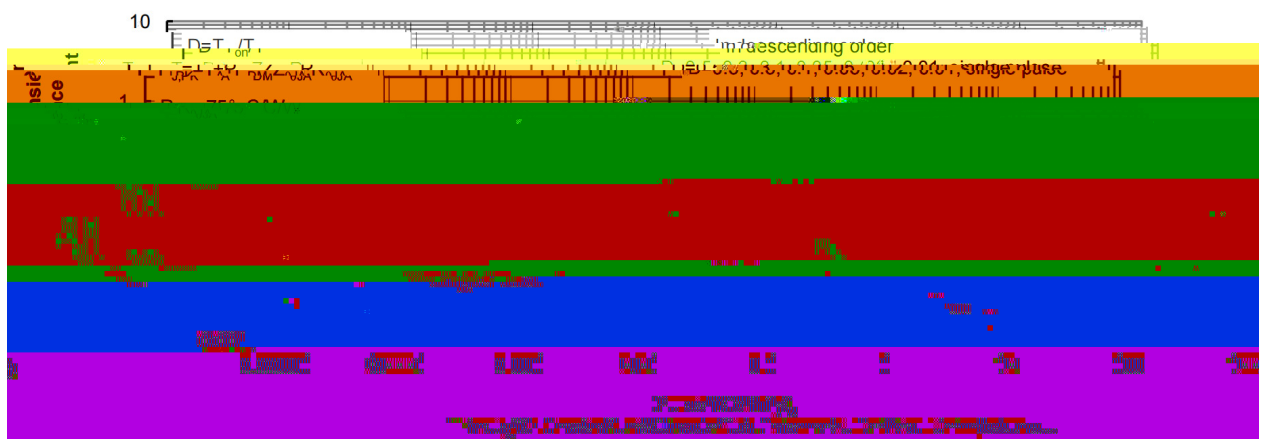
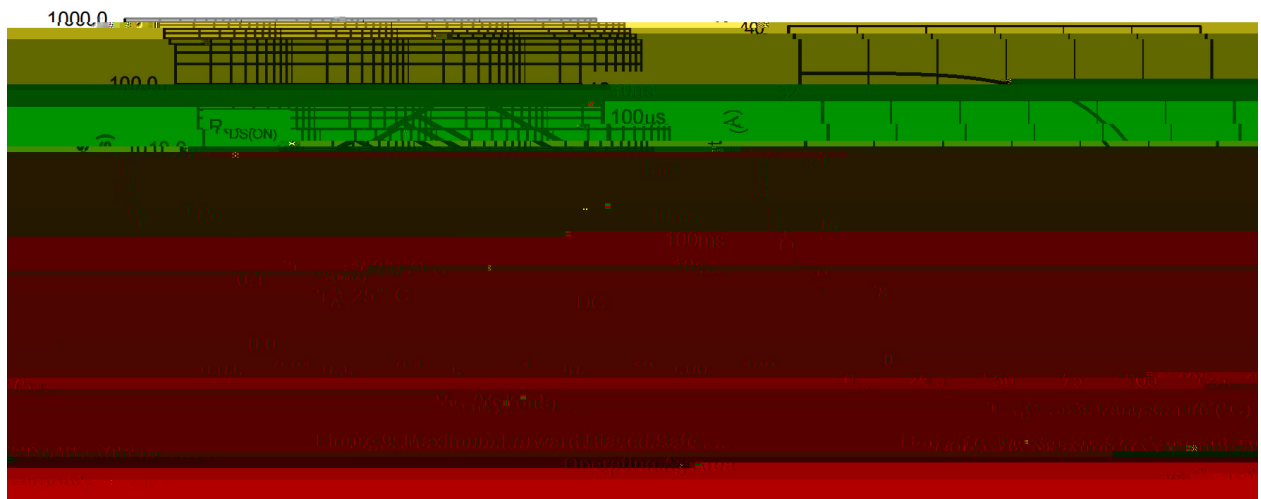
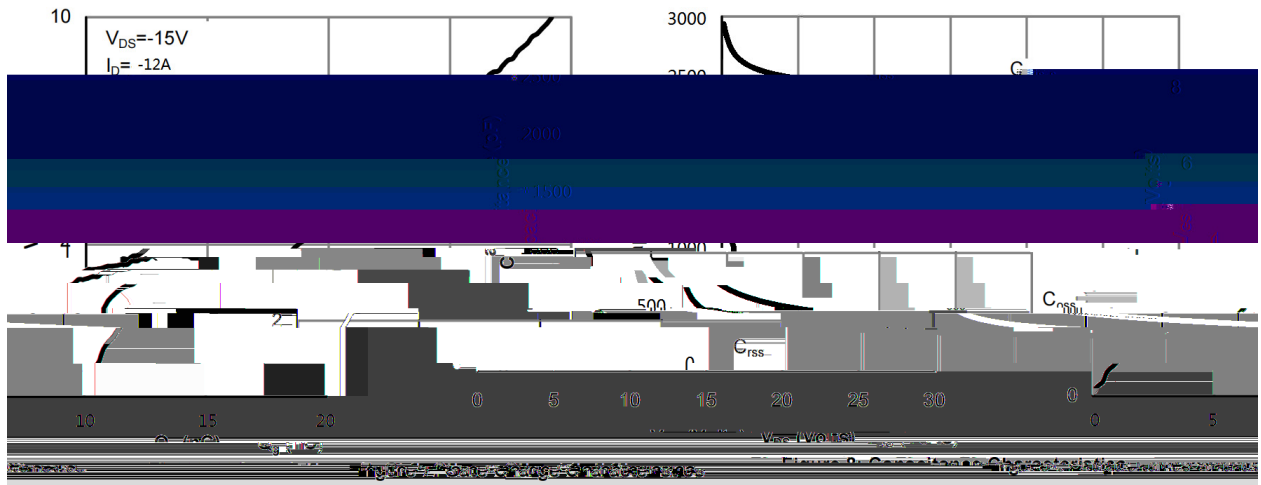

PDFN3X3A-8L

Unit:mm

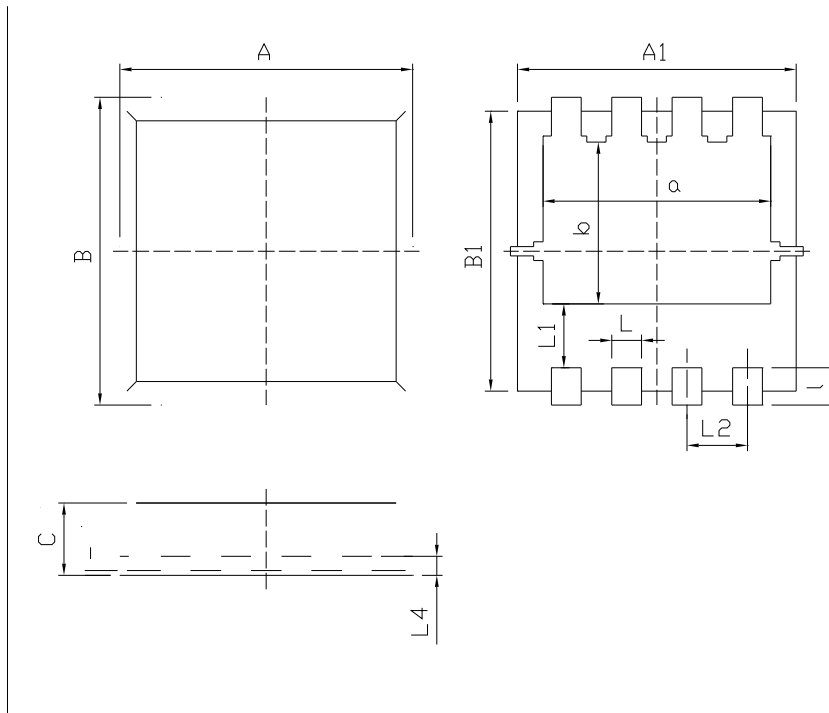

Dimensions In Millimeterer			
Symbol	MIN	TYP	MAX
A	3.20	3.30	3.40
A1	3.10	3.15	3.20
B	3.20	3.30	3.40
B1	2.95	3.00	3.05
C	0.75	0.80	0.85
L	0.25	0.30	0.35
L1	-	-	0.75
L2	0.55	0.65	0.75
L4	0.14	0.15	0.20
a	2.35	2.45	2.55
b	1.635	1.735	1.835
k	0.00	-	0.05
l	0.30	0.40	0.50

Rev.00 202011

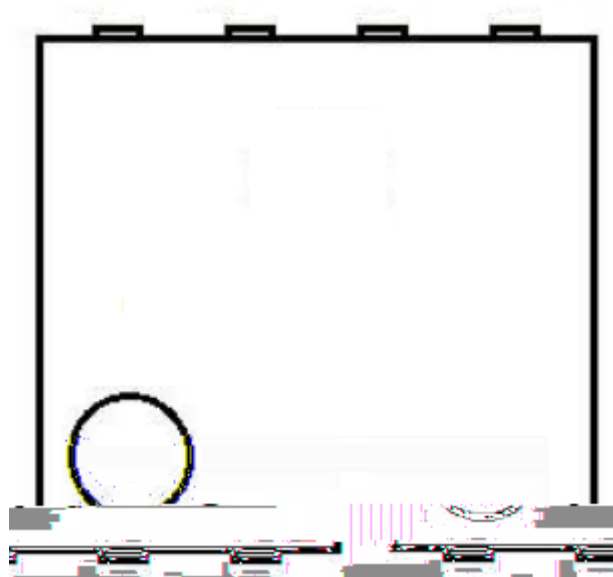

BR

Q

140P03

!!!!

Note:

BR:

Temperature Profile for IR Reflow Soldering(Pb-Free)

Note:

- | | | | | | |
|---|--------|-----|------------|---------|---|
| 1 | 150 | 200 | 60 | 120sec; | 1.Preheating:150~200 , Time:60~120sec. |
| 2 | 255..5 | | 5..0.5sec; | | 2.Peak Temp.:255..5 , Duration:5..0.5sec. |
| 3 | | 2 | 10 | /sec. | 3. Cooling Speed: 2~10 /sec. |

260..5	10..1 sec.	Temp.:260±5	Time:10±1 sec
--------	------------	-------------	---------------

/ REEL

Package Type	Units					Dimension (unit mm ³)		
	Units/Reel /	Reels/Inner Box /	Units/Inner Box /	Inner Boxes/Outer Box /	Units/Outer Box /	Reel	Inner Box	Outer Box