

5 é / Descriptions

TO-252 N 700V Super-Junction Power MOSFET in a TO-252 Plastic Package.

α^a / Features

Low R_{DS(on)}, low gate charge, low C_{rss}, fast switching, HF Product.

Đ ÷ / Applications

Suited for low voltage applications such as automotive, DC/DC Converters, and high efficiency switching for power management in portable and battery operated products.

Ã W] Ô . / Equivalent Circuit

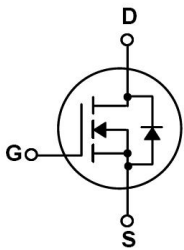

• Ū - æ / Pinning

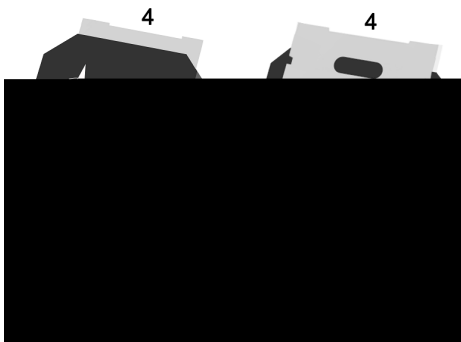

PIN 1 y G

PIN 2 y D

PIN 3 y S

PIN 4 y D

, M V / Marking

• - ~^a ϕ ož

See Marking Instructions.

BRD70R900C

@ f Parameter	... Z Symbol	y i Ú ^ Test Conditions	Â 4 › Min	Á ° › Typ	Â Ý › Max	% y Unit
Continuous Diode Forward Current	I _s				5.5	A
Total Gate Charge	Q _g	V _{DS} =560V I _D =5.0A V _{GS} =10V		13		nC

Electrical Characteristic Curve

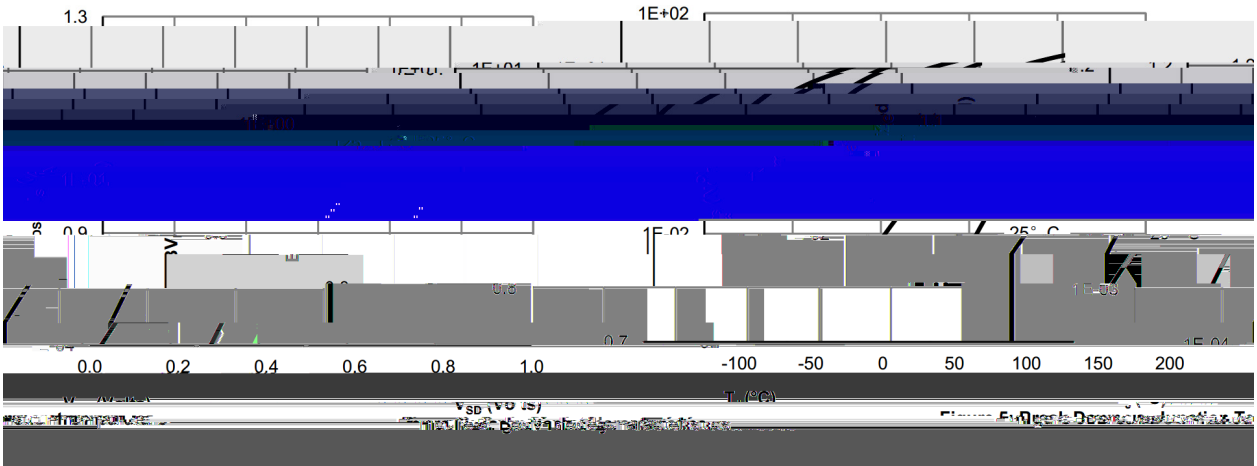
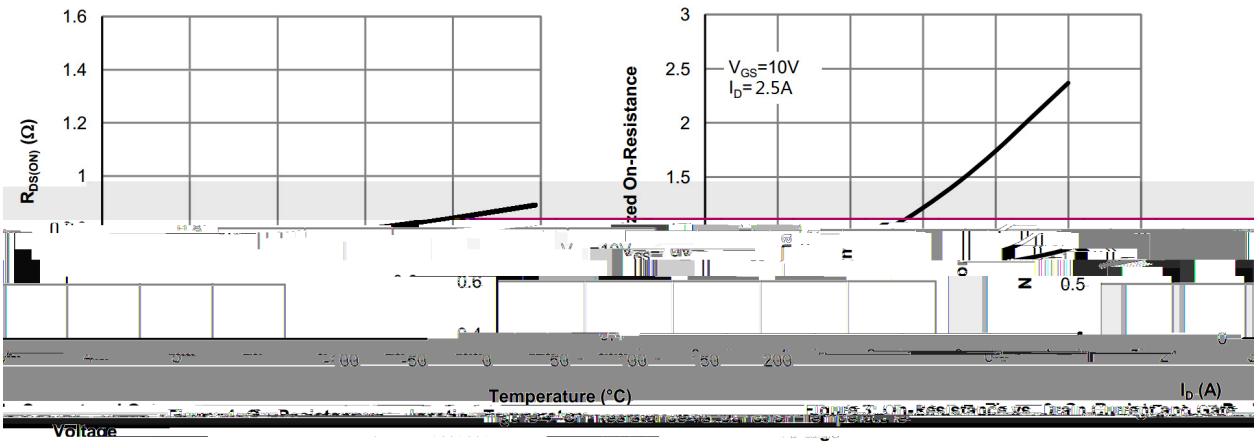
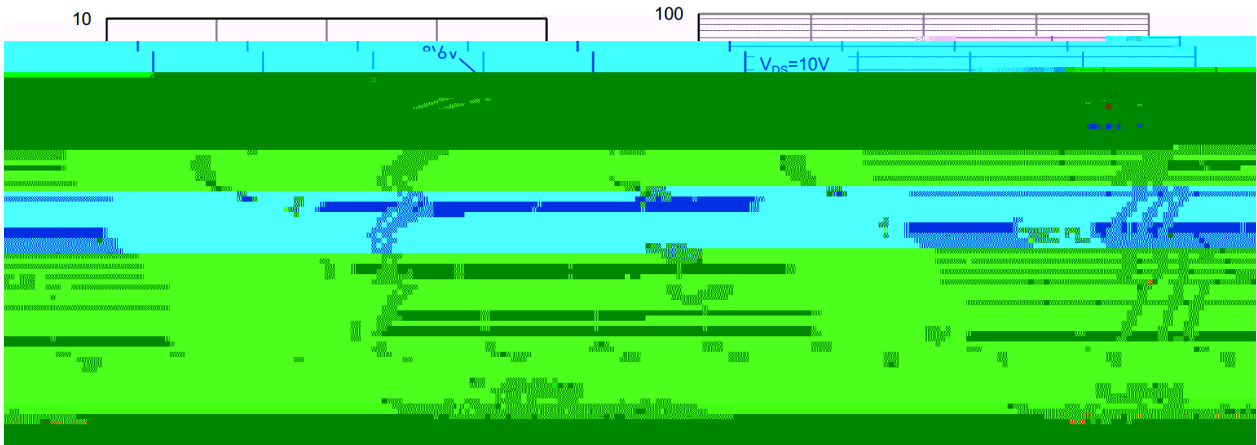

Ø □ =) φ / Package Dimensions

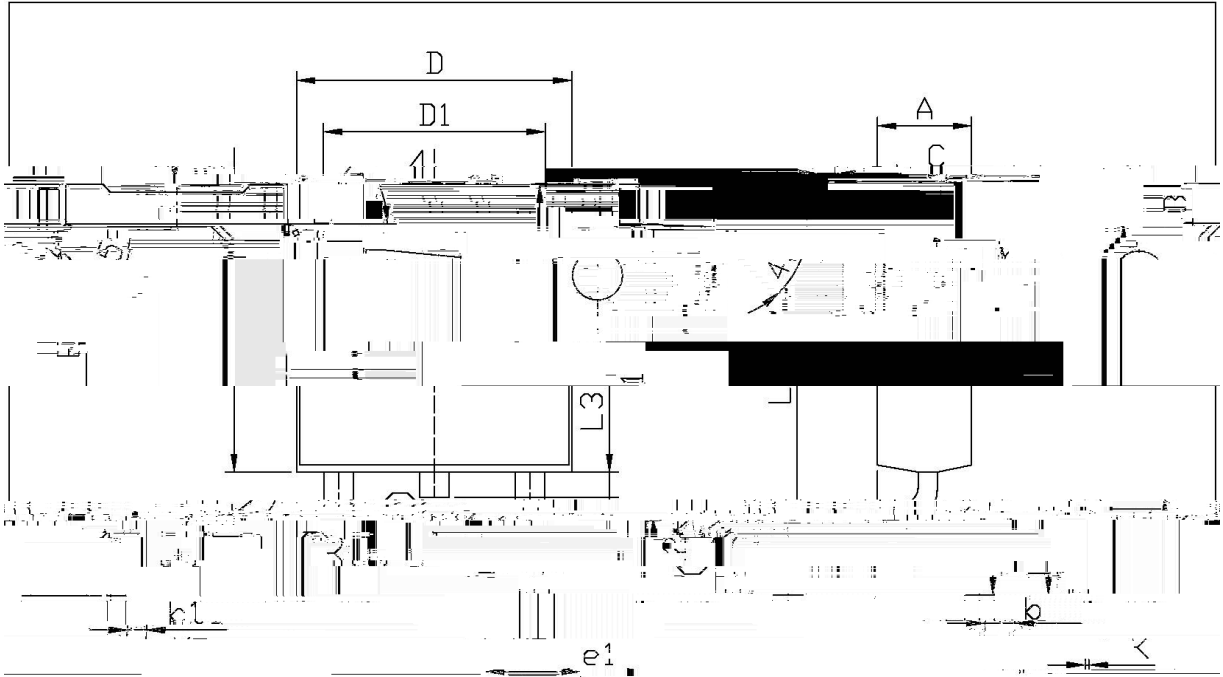

单位: mm

Dimensions		Millimeters		Dimensions		In Millimeters	
Min	Max	Symbol	Value	Min	Max	Symbol	Value
2.34		B	0.95	1.25		e1	2.24
4.72			0.70	0.00			4.75
4.72		b	0.45	0.55			0.95
10.16			0.45	0.55			10.35
0.10			0.10	0.50			0.50

T0-252

, M y f / Marking Instructions

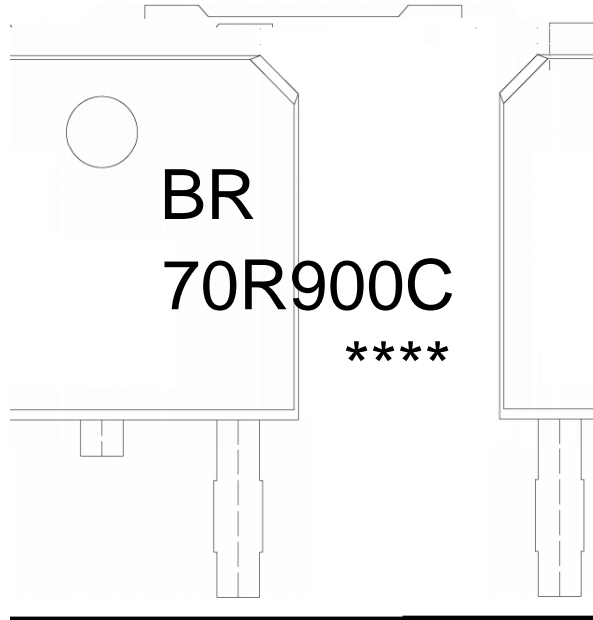

^a ç y
BR y , [W A
8) y ° Z W A
y ÿ D Z W A k š ÿ D Z J

Note:

- BR: Company Code
- 70R900C: Product Type Code
- ****: Lot No. Code, code change with Lot No

BRD70R900C
Rev.A Jul.-2024