

DFN 1006-2L

ESD



μ			
μ			
		\pm	
		\pm	

--	--	--	--	--	--	--	--

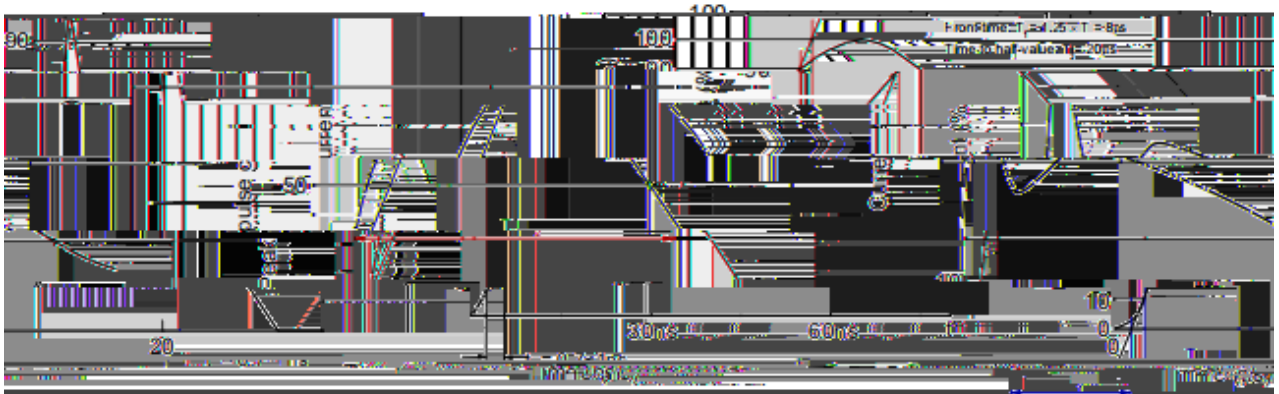

EC61000-4-5 Contact discharge current waveform per EC61000-4-2 8/20 μ s waveform

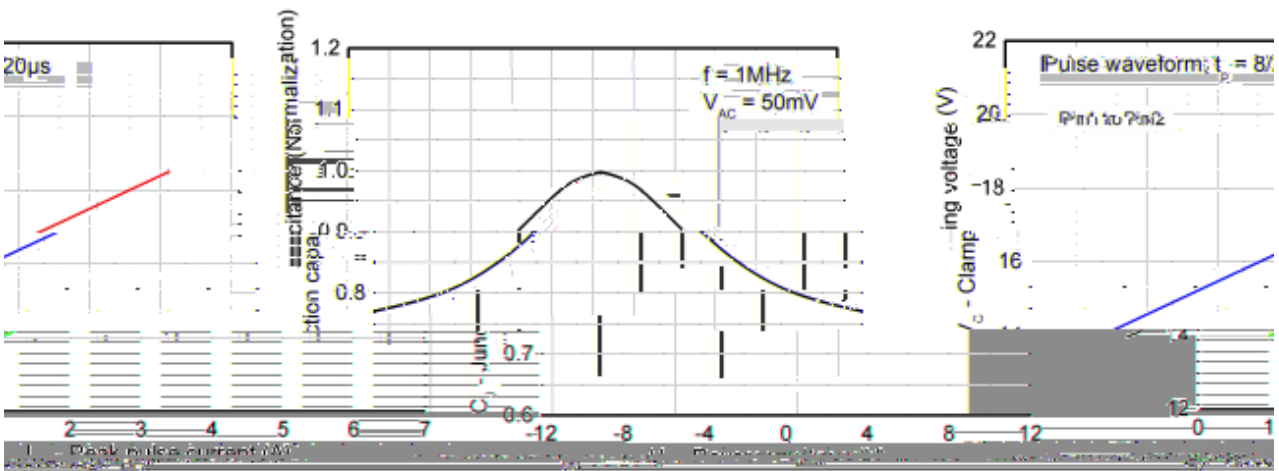

Capacitance vs. Reverse voltage Clamping voltage vs. Peak pulse current Capacitance vs. Peak pulse current

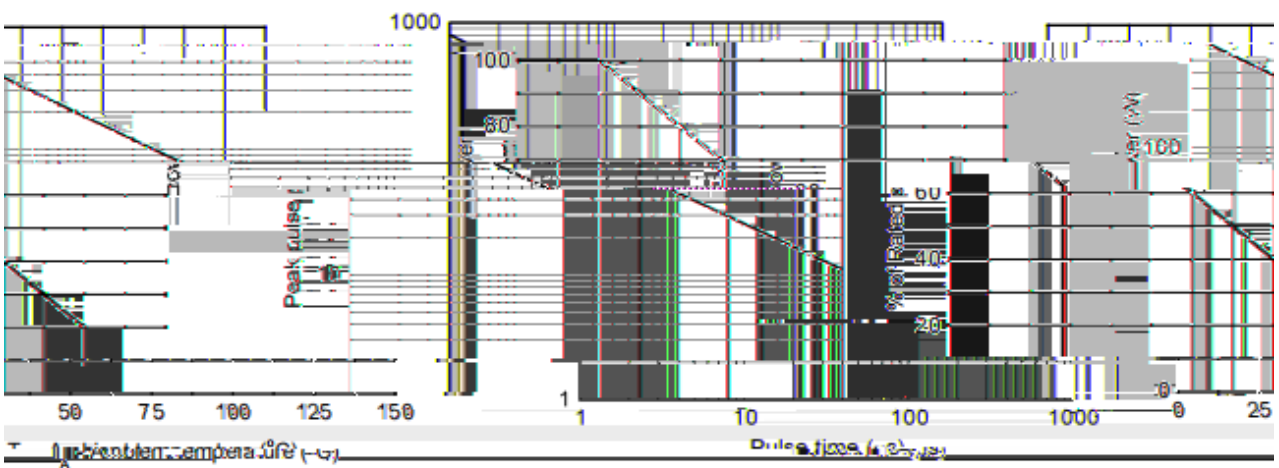

Ambient temperature (°C) Pulse time (s)

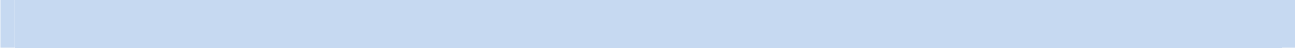

DFN1006-2L

Unit:mm

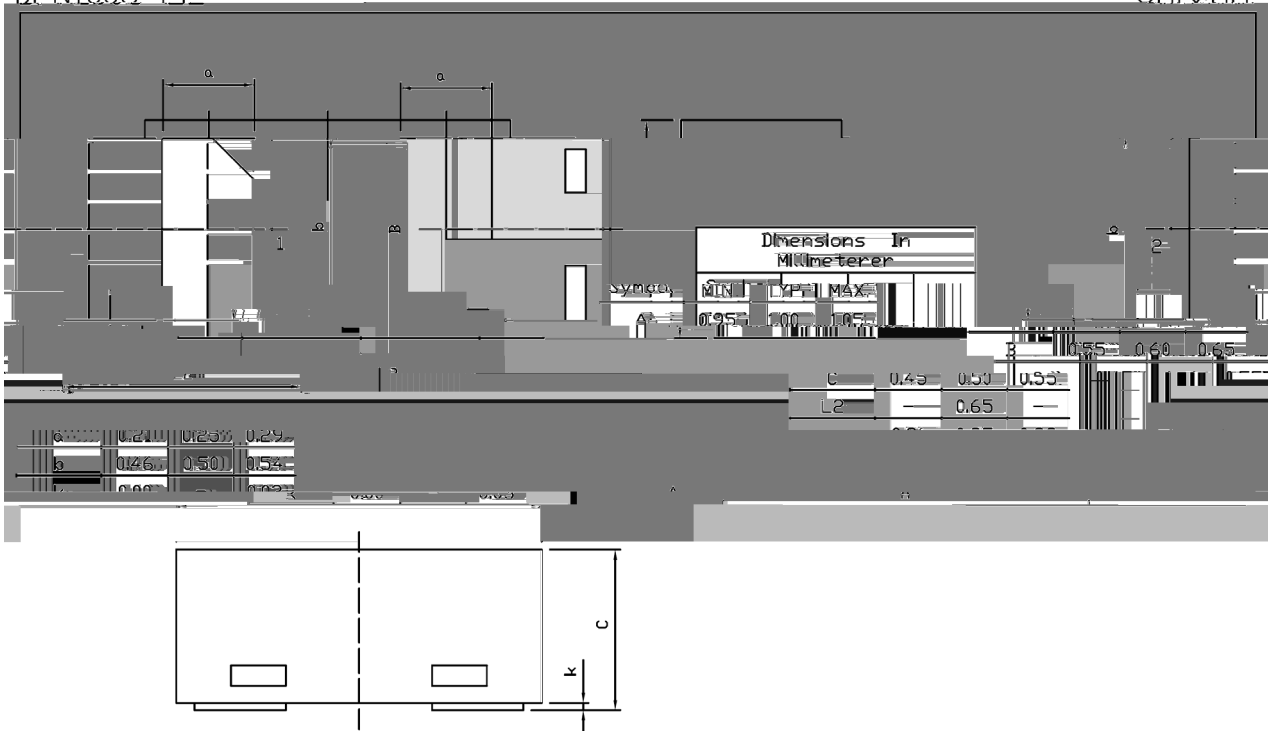

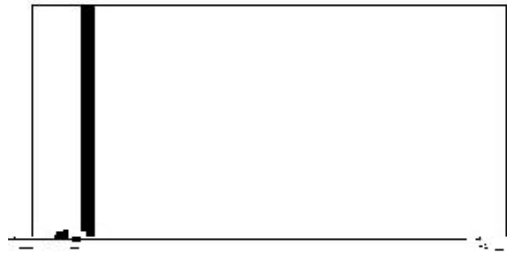

cD

Temperature Profile for IR Reflow Soldering(Pb-Free)

±

±

±

±