

- / Descriptions

/ Features

/ Applications

DC/DC

/ Equivalent Circuit

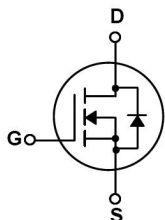

/ Pinning

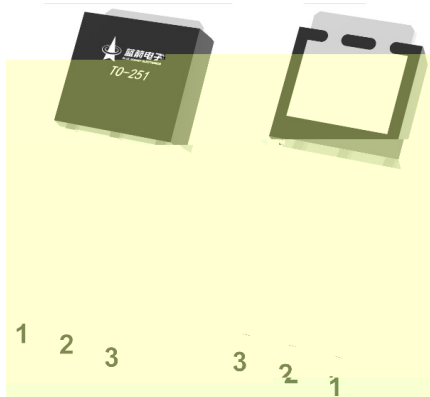

/ Marking

BRI7N65



DATA SHEET

| | | | |
|--|--|--|--|
| | | | |
| | | | |
| | | | |
| | | | |
| | | | |
| | | | |
| | | | |
| | | | |

/ Electrical Characteristic Curve

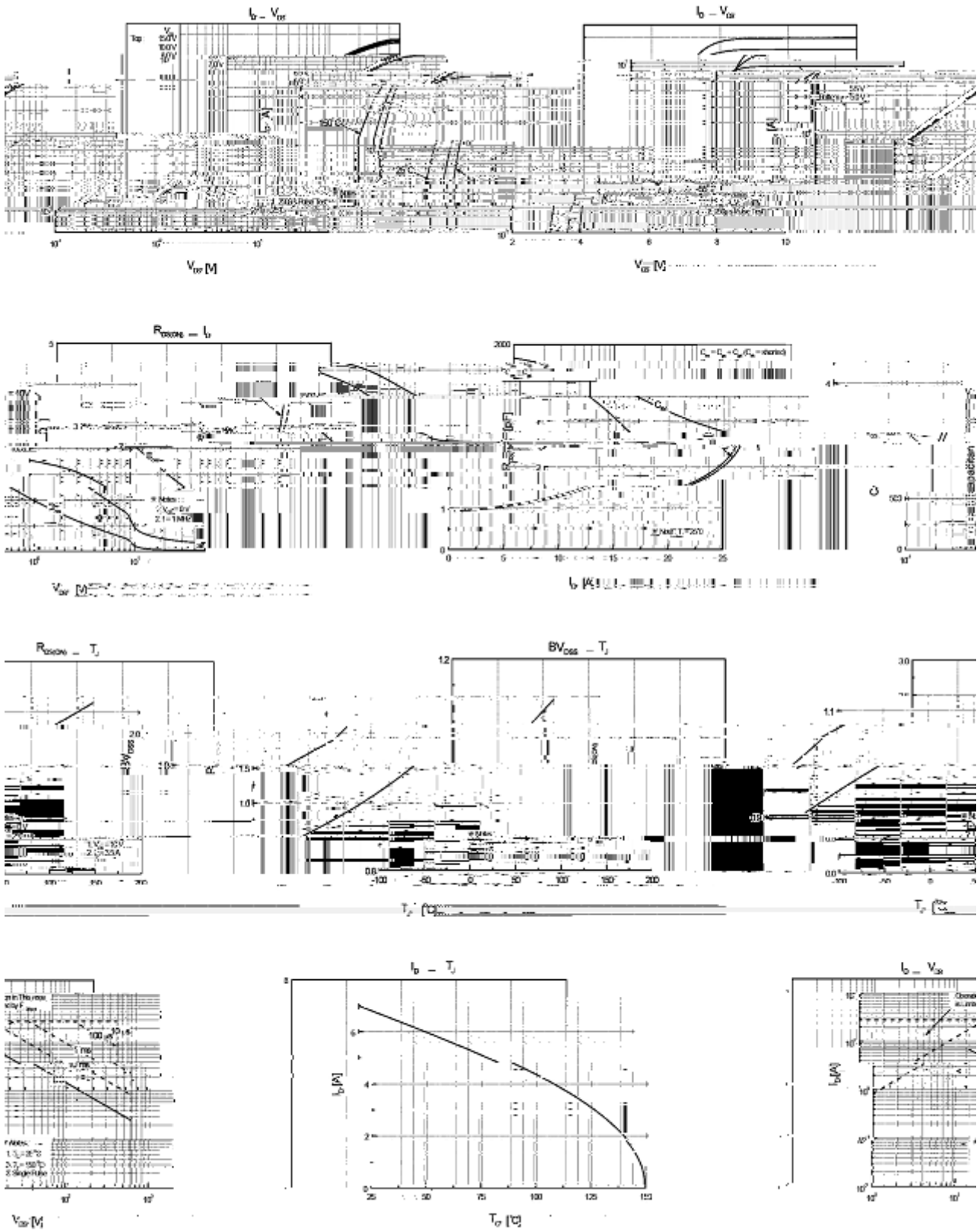

/ Package Dimensions

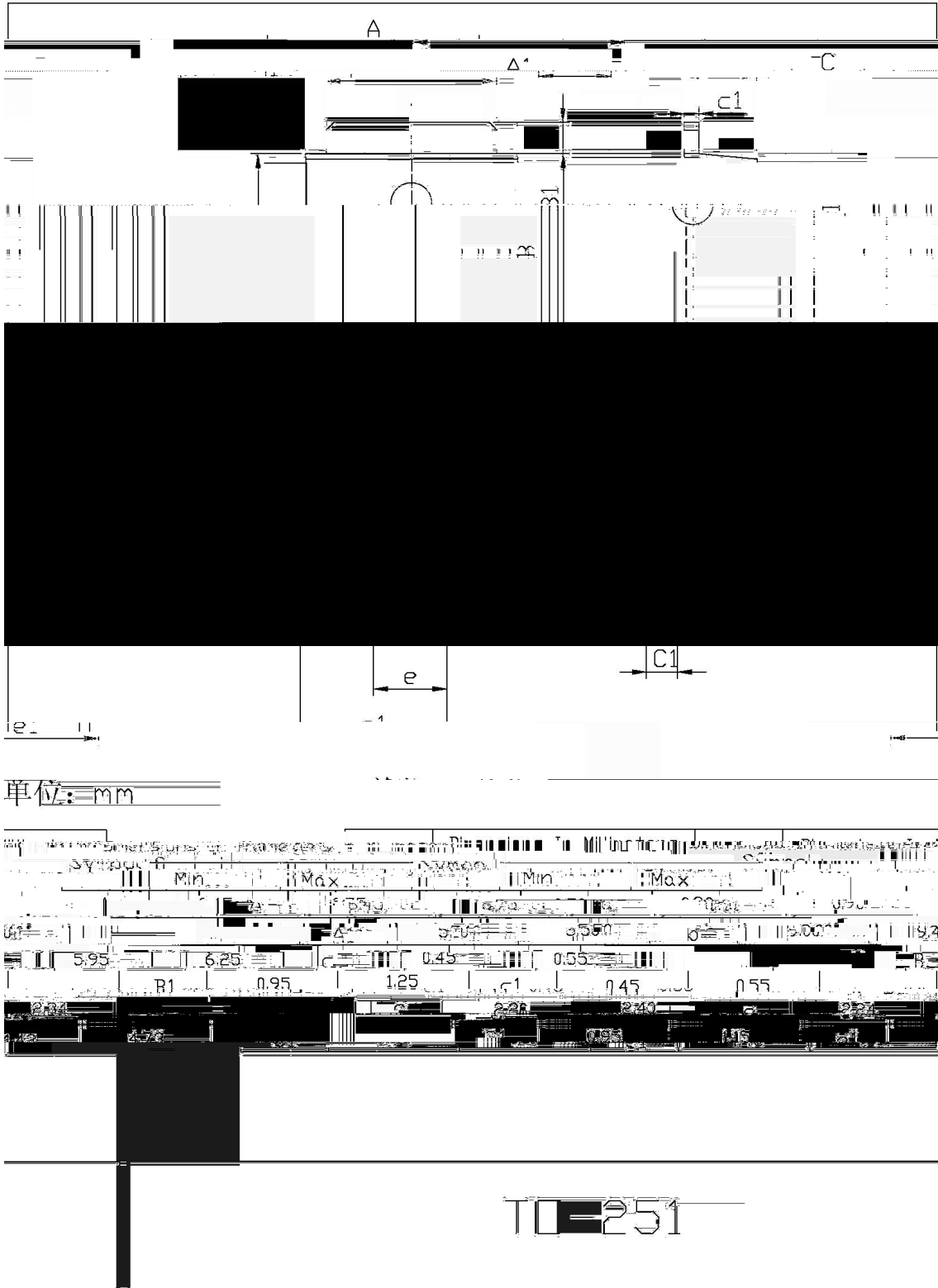

/ Marking Instructions

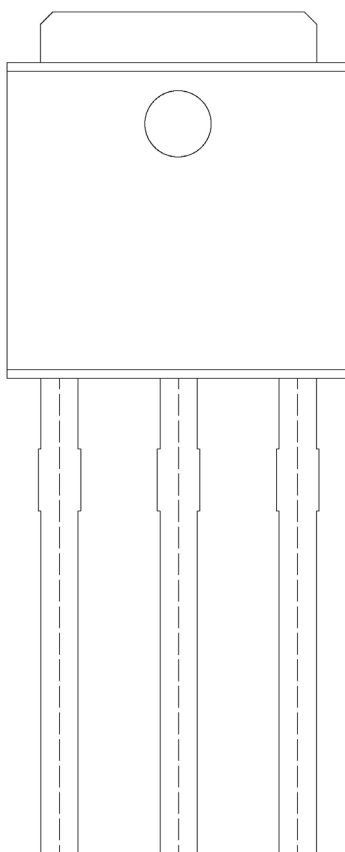

7N65
