

Rev.E Mar.-2016

TO-92          NPN          Silicon NPN transistor in a TO-92 Plastic Package.

 $V_{CE0}$  , KSA708

 High  $V_{CE0}$ , Complementary pair with KSA708.

Low frequency amplifier, medium speed switching.

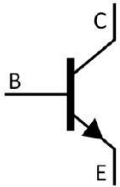

PIN1 Collector          PIN 2 Base          PIN 3 Emitter

$h_{FE}$ Classifications Symbol	R	O	Y	G
$h_{FE}$ Range	40~80	70~140	120~240	200~400

Parameter	Symbol	Rating	Unit
Collector to Base Voltage	$V_{CBO}$	80	V
Collector to Emitter Voltage	$V_{CEO}$	60	V
Emitter to Base Voltage	$V_{EBO}$	8.0	V
Collector Current - Continuous	$I_C$	700	mA
Collector Power Dissipation	$P_C$	800	mW
Junction Temperature	$T_j$	150	
Storage Temperature Range	$T_{stg}$	-55 150	

Parameter	Symbol	Test Conditions	Min	Typ	Max	Unit
Collector to Base Breakdown Voltage	$V_{CBO}$	$I_C=100\mu A$ $I_E=0$	80			V
Collector to Emitter Breakdown Voltage	$V_{CEO}$	$I_C=10mA$ $I_B=0$	60			V
Emitter to Base Breakdown Voltage	$V_{EBO}$	$I_E=-10\mu A$ $I_C=0$	8.0			V
Collector Cut-Off Current	$I_{CBO}$	$V_{CB}=60V$ $I_E=0$			0.1	$\mu A$
Emitter Cut-Off Current	$I_{EBO}$	$V_{EB}=5.0V$ $I_C=0$			0.1	$\mu A$
DC Current Gain	$h_{FE}$	$V_{CE}=2.0V$ $I_C=50mA$	40		400	
Collector to Emitter Saturation Voltage	$V_{CE(sat)}$	$I_C=500mA$ $I_B=50mA$		0.2	0.4	V
Base to Emitter Saturation Voltage	$V_{BE(sat)}$	$I_C=500mA$ $I_B=50mA$		0.86	1.1	V
Transition Frequency	$f_T$	$V_{CE}=10V$ $I_C=50mA$	30	50		MHz
Collector Output Capacitance	$C_{ob}$	$V_{CB}=10V$ $I_E=0$ $f=1.0MHz$		8.0		pF



T0-92

Unit: mm

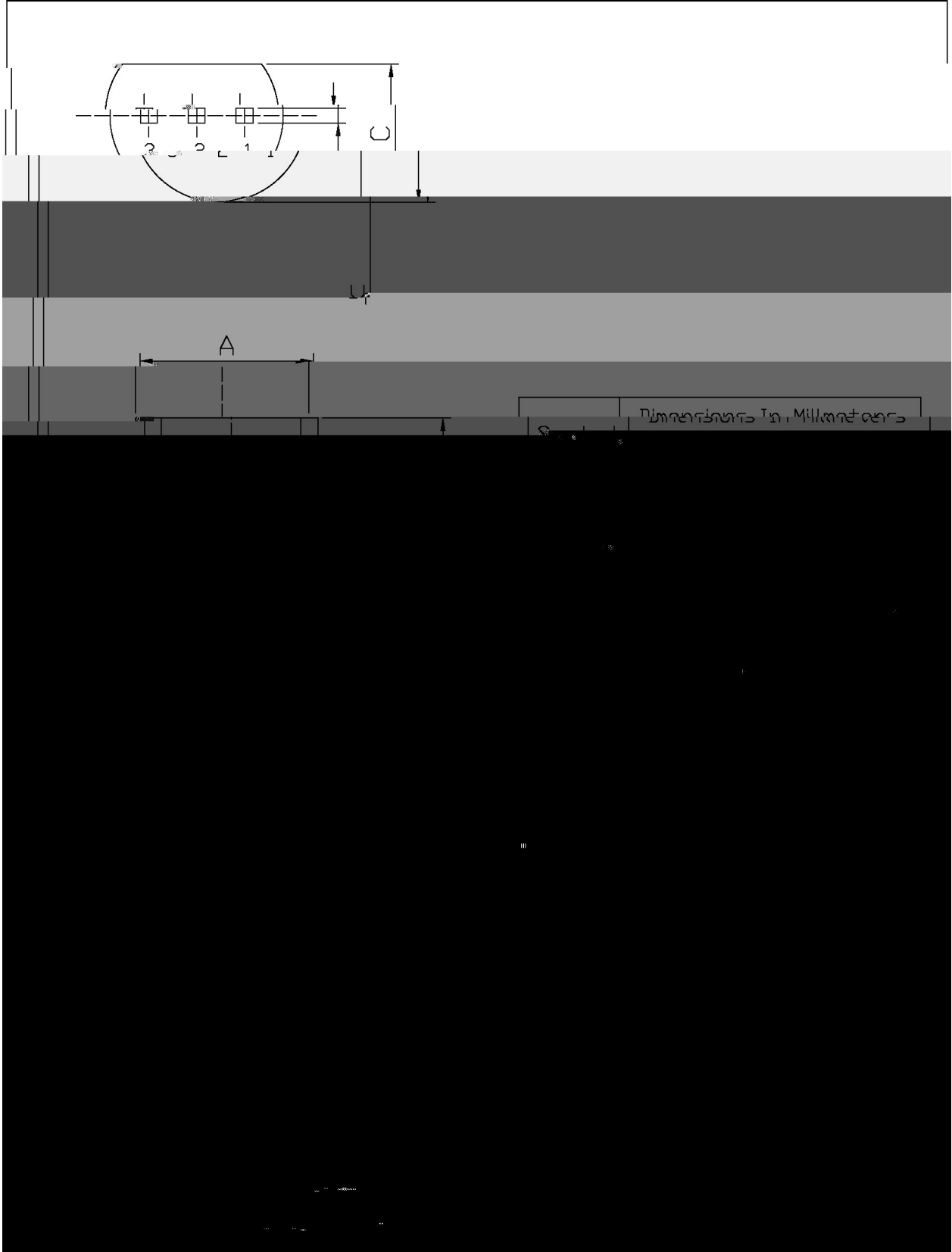

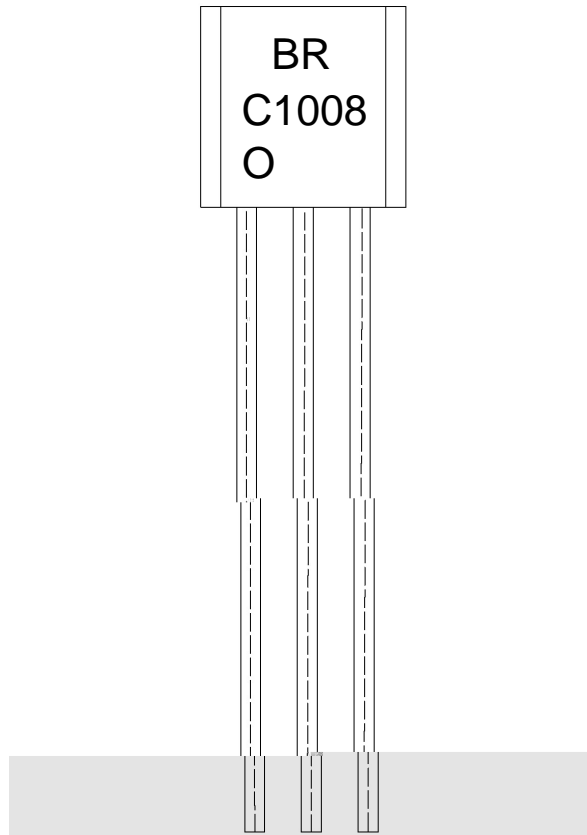

BR:

C1008

O:  $h_{FE}$

\*\*\*\*

Note:

BR: Company Code.

C1008: Product Type.

O:  $h_{FE}$  Classifications Symbol

\*\*\*\*: Lot No. Code,code change with Lot No.



1	25	150	60	90sec;	Note:	1.Preheating:25~150 , Time:60~90sec.
2	255±5		5±0.5sec;		2.Peak Temp.:255±5 , Duration:5±0.5sec.	
3		2	10	/sec.	3. Cooling Speed: 2~10 /sec.	

270±5	10±1 sec.	Temp:270±5	Time:10±1 sec
-------	-----------	------------	---------------

/ BULK

Package Type	Units	Dimension 314	0
--------------	-------	---------------	---