

/ Descriptions

Silicon NPN transistor in a TO-92 Plastic Package.

/ Features

Complement to KSA642, $P_C=400mW$.

/ Applications

Low frequency power amplifier.

/ Equivalent Circuit

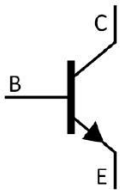

/ Pinning



PIN1 Collector PIN 2 Base PIN 3 Emitter

/ hFE Classifications & Marking

| | | | |
|---|--------|---------|---------|
| h _{FE} Classifications Symbol | O | Y | G |
| h _{FE} Range | 70~140 | 120~240 | 200~400 |

Parameter

Symbol

/ Electrical Characteristic Curve

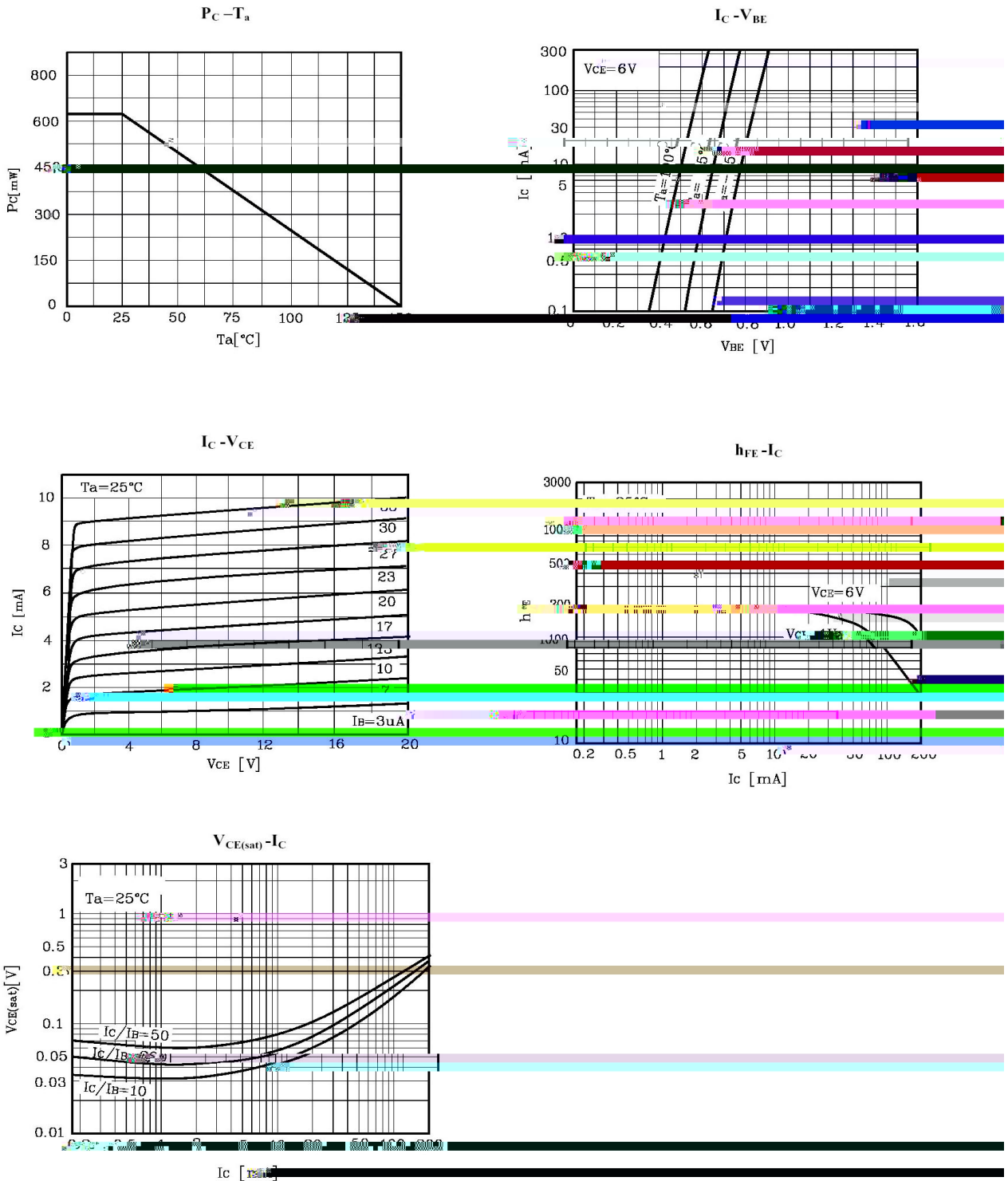

/ Package Dimensions

T0-92

Unit: mm

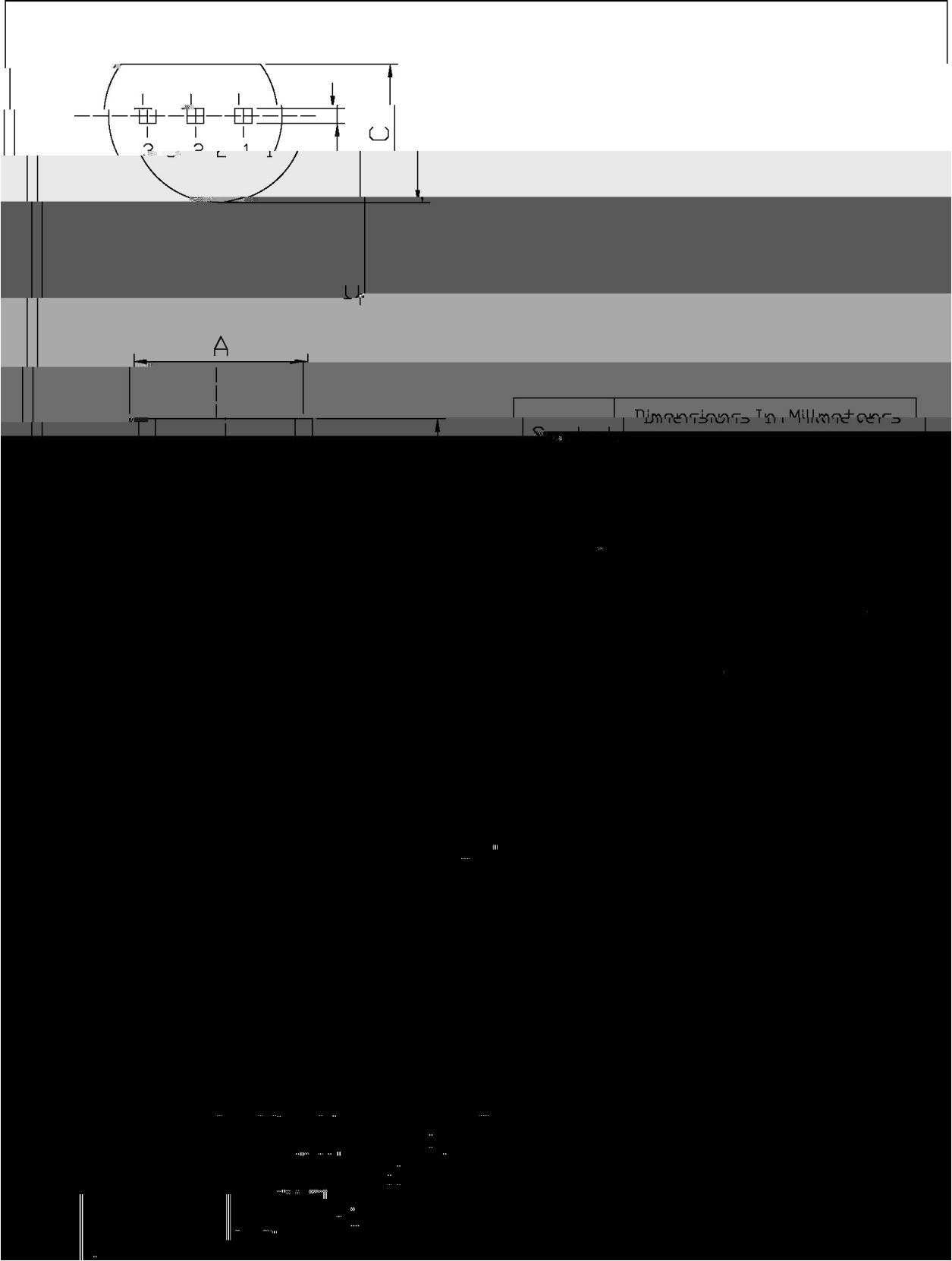

/ Marking Instructions

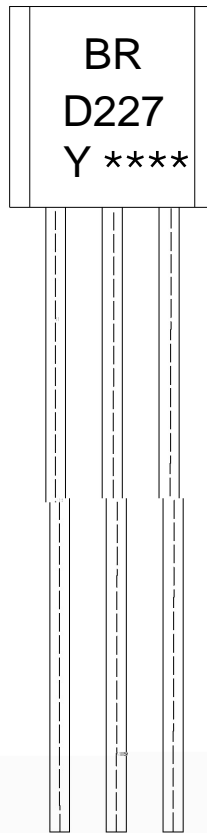

Note:

BR: Company Code.

D227: Product Type.

Y: h_{FE} Classifications Symbol

****: Lot No. Code, code change with Lot No.

() / Temperature Profile for Dip Soldering(Pb-Free)

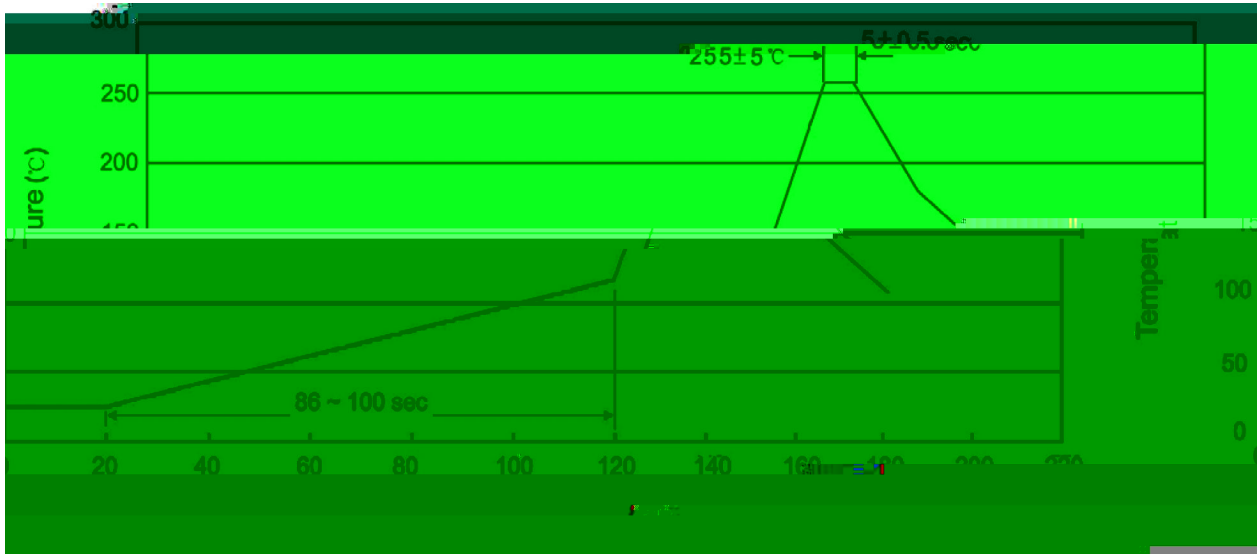

Note:

- | | | | | | |
|---|-----|-----|----|----------|---|
| 1 | 25 | 150 | 60 | 90sec; | 1.Preheating:25~150 , Time:60~90sec. |
| 2 | 255 | 5 | 5 | 0.5sec; | 2.Peak Temp.:255 5 , Duration:5 0.5sec. |
| 3 | | | 2 | 10 /sec. | 3. Cooling Speed: 2~10 /sec. |

/ Resistance to Soldering Heat Test Conditions

270 5 10 1 sec. Temp:270±5 Time:10±1 sec

/ Packaging SPEC.

/ BULK

| Package Type | Units | | | | | Dimension (unit mm3) | | |
|--------------|-------------|------------------|-------------------|-------------------------|-------------------|----------------------|-------------|-------------|
| | Units/Bag / | Bags/Inner Box / | Units/Inner Box / | Inner Boxes/Outer Box / | Units/Outer Box / | Bag | Inner Box | Outer Box |
| TO-92 | 1,000 | 10 | 10,000 | 5 | 50,000 | 135×190 | 237×172×102 | 560×245×195 |
| | 1,000 | 10 | 10,000 | 10 | 100,000 | 135×190 | 237×172×102 | 560×245×375 |

/ AMMO

| Package Type | Units | | | | | Dimension (unit mm3) | |
|--------------|--------------|------------------|------------------|-------------------------|-------------------|----------------------|----------------------------|
| | Units/tape / | Tape/Inner Box / | Rows/Inner Box / | Inner Boxes/Outer Box / | Units/Outer Box / | Inner Box | Outer Box |
| TO-92 | 3,000 | 1 | 120 | 10 | 30,000 | 328×230×42 | 480×346×235 547×407×268 |

/ Notices