

MAC97A6
Rev.E Mar.-2016

TO-92

Triac in a TO-92 Plastic Package.

Sensitive Gate Triggering in Four Trigger Modes fo

| Parameter | Symbol | Rating | Unit |
|--------------------------------------|---------------------|--------|--------|
| Repetitive peak off-state voltages | V_{DRM} | 400 | V |
| RMS on-state current | $I_{T(RMS)}$ | 0.6 | A |
| Non-repetitive peak on-state current | $I_{TSM(t=20ms)}$ | 8.0 | A |
| Non-repetitive peak on-state current | $I_{TSM(t=16.7ms)}$ | 8.8 | A |
| I_t for fusing | I_t^2 | 0.32 | A^2S |

Repetitive rate of rise of on-

| Parameter | Symbol | Test Conditions | Min | Typ | Max | Unit |
|--|-----------|--|-----|-----|-----|------|
| Gate trigger voltage | V_{GT} | $V_D=12V$ $I_T=0.1A$ | | 0.9 | 2.0 | V |
| | | $V_D=V_{DRM}$ $I_T=0.1A$ $T_J=110$ | 0.1 | 0.7 | | |
| Off-state leakage current | I_D | $V_D=V_{DRM(max)}$ $T_J=110$ | | 3.0 | 100 | A |
| Gate Controlled Turn-On Time | tgt | $I_{TM}=1.0A$ $V_D=V_{DRM}$ $I_G=25mA, dI_G/dt=5A/s$ | | 2.0 | | s |
| Critical Rate-of-Rise of Commutation Voltage | dV_D/dt | $V_D=67\%$ of $V_{DM(max)}$, $T_{case}=110$ exponential waveform gate open circuit | 30 | 45 | | V/ s |

/ Package Dimensions

TO-92

Unit: mm

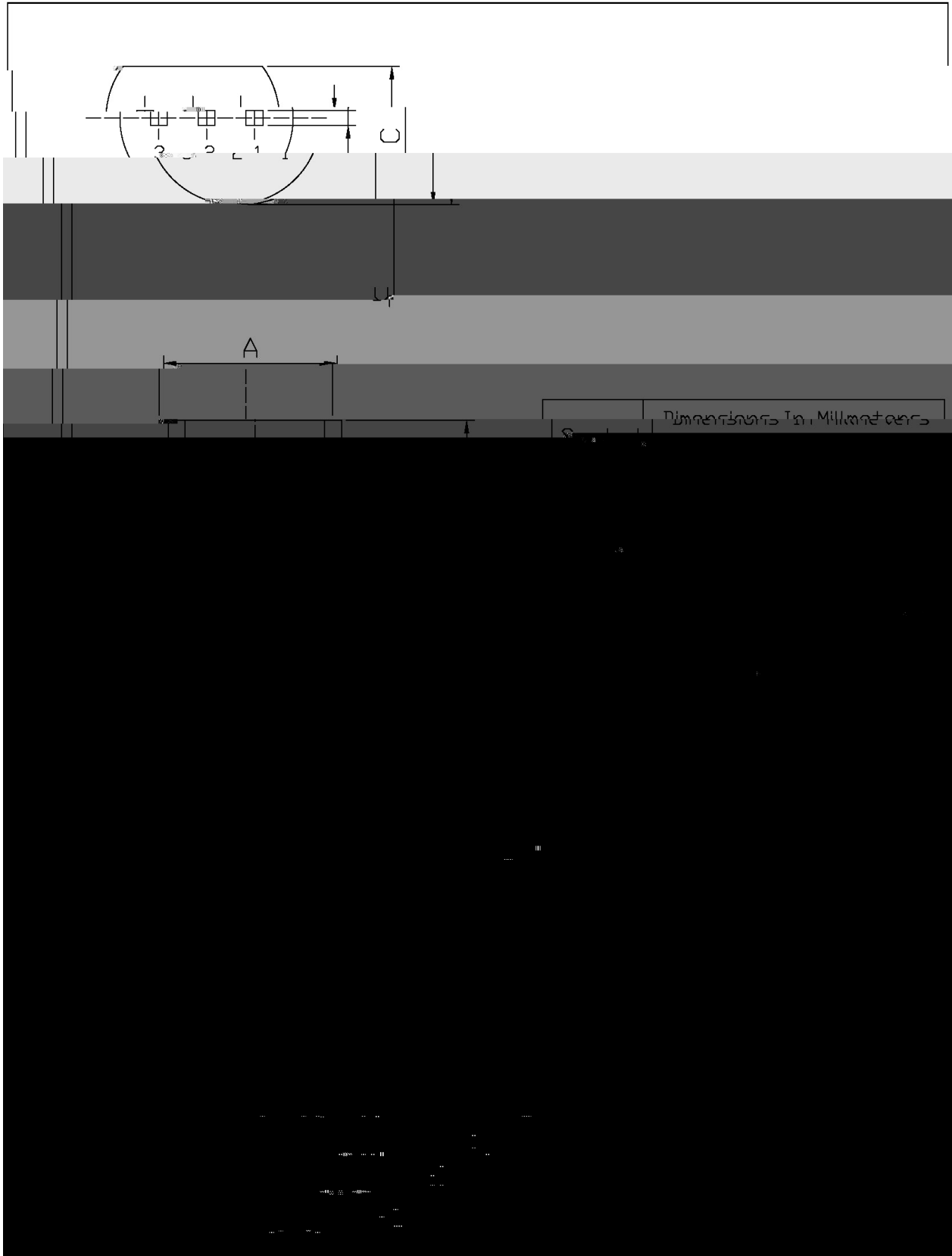

/ Marking Instructions

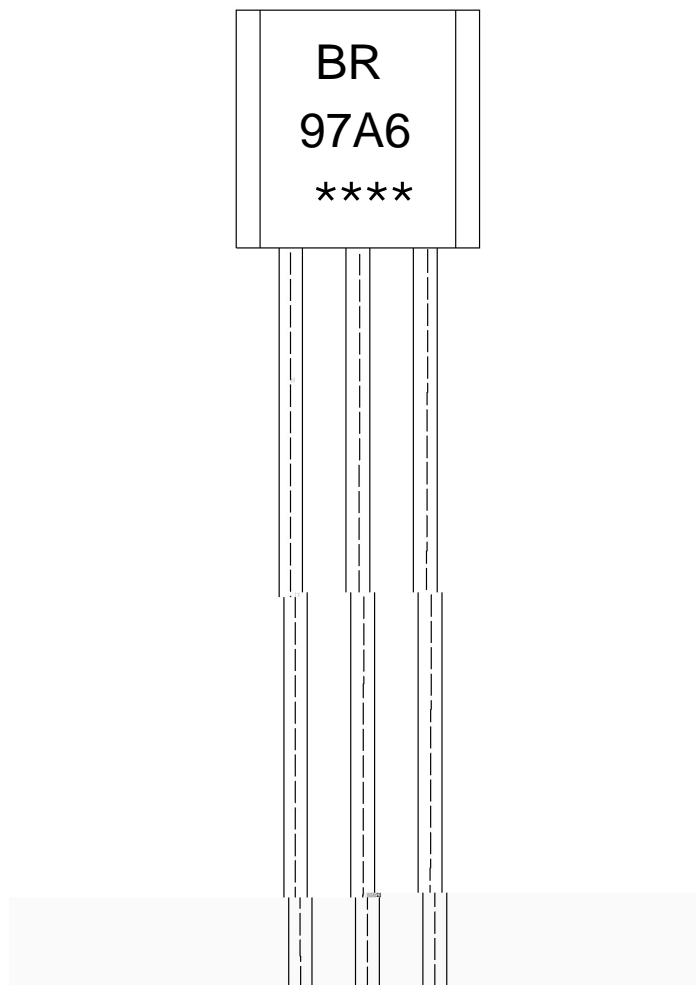

BR

97A6

Note:

BR: Company Code.

97A6: Product Type.

****: Lot No. Code, code change with Lot No.

() / Temperature Profile for Dip Soldering(Pb-Free)

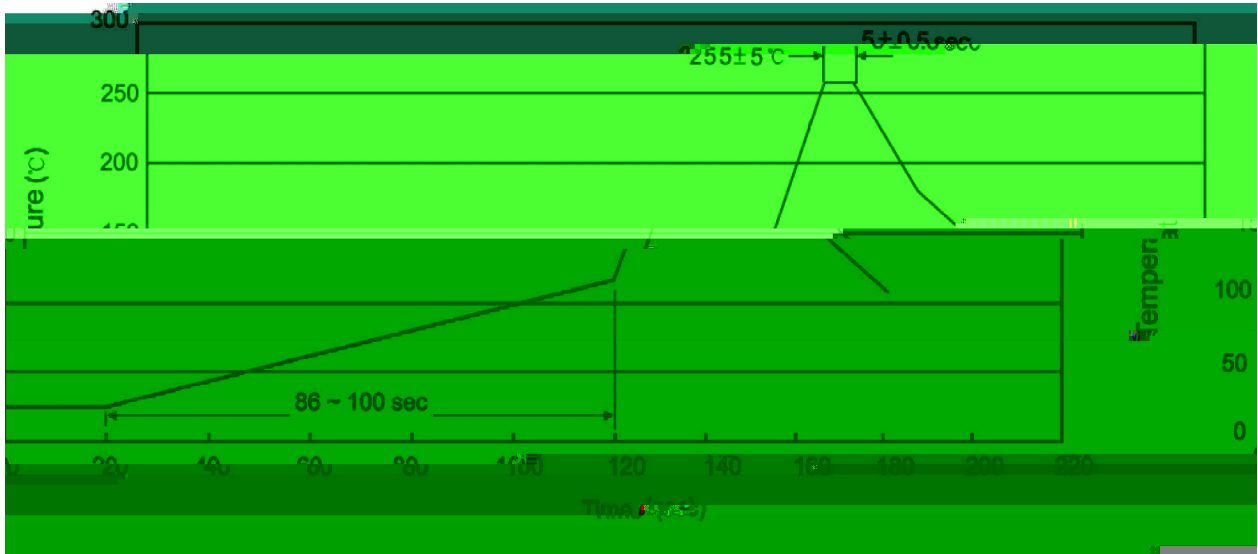

Note:

- | | | | | | |
|---|-------|-----|-----------|--------|---|
| 1 | 25 | 150 | 60 | 90sec; | 1.Preheating:25~150 , Time:60~90sec. |
| 2 | 255±5 | | 5±0.5sec; | | 2.Peak Temp.:255±5 , Duration:5±0.5sec. |
| 3 | | 2 | 10 | /sec. | 3. Cooling Speed: 2~10 /sec. |

/ Resistance to Soldering Heat Test Conditions

270±5 10±1 sec. Temp.:270±5 Time:10±1 sec

/ Packaging SPEC.

/ BULK

| Package Type 封装形式 | Units 包装数量 | | | | | Dimension 包装尺寸 (unit: mm3) | | |
|----------------------|------------------|-----------------------|------------------------|------------------------------|------------------------|----------------------------|-------------|-------------|
| | Units/Bag 只/袋 | Bags/Inner Box 袋/盒 | Units/Inner Box 只/盒 | Inner Boxes/Outer Box 盒/箱 | Units/Outer Box 只/箱 | Bag 袋 | Inner Box 盒 | Outer Box 箱 |
| TO-92 | 1,000 | 10 | 10,000 | 5 | 50,000 | 135×190 | 237×172×102 | 560×245×195 |
| | 1,000 | 10 | 10,000 | 10 | 100,000 | 135×190 | 237×172×102 | 560×245×375 |

/ AMMO

| Package Type 封装形式 | Units 包装数量 | | | | | Dimension 包装尺寸 (unit: mm3) | |
|----------------------|--------------------|------------------------|-------------------------|------------------------------|------------------------|----------------------------|-----------------------------------|
| | Units/tape 只/纸带 | Tape/Inner Box 纸带/盒 | Rows/Inner Box 纸带层/盒 | Inner Boxes/Outer Box 盒/箱 | Units/Outer Box 只/箱 | Inner Box 盒 | Outer Box 箱 |
| TO-92 | 3,000 | 1 | 120 | 10 | 30,000 | 328×230×42 | 小箱 480×346×235, 大箱 547×407×268 |

/ Notices